

NOTICE!!

These documents have been scanned!

Do not place un-scanned documents beneath this notice!

Do not remove this notice from this file!

GPO Jacket No. 560-102
Print Order 61540
Rise Business Services, LLC
Job=AZ15 5/28/2019



Box Number= AZ15090



Claim Begin-End: AMC383267-AMC383270

1 Initial Receipt



AZ15090-10

AMC381882-AMC383274

United States Department of the Interior
 Bureau of Land Management
 BUSINESS & SUPPORT SVCS DIV
 ONE N CENTRAL AVE SUITE 800
 PHOENIX, AZ 85004 -4427
 Phone: (602) 417-9200

Receipt

No:

1500196

Transaction #: 1550412	ENTERED INTO COMPUTER
Date of Transaction: 05/31/2007	
CUSTOMER: PETER MEYERS P.M. EXPLORATION LLC 2207 CRESCENT DR DODGE CITY,KS 67801	JUN 04 2007 <i>PS</i>

LINE #	QTY	DESCRIPTION	REMARKS	UNIT PRICE	TOTAL
1	4.00	LOCATABLE MINERALS / MINING CLAIMS- NEW,UNADJUD, ONE OR MORE AUTH NOS / NEW MINING CLAIM PROCESSING FEE \$15 (1930) CASES: AMC383267/\$15.00, AMC383268/\$15.00, AMC383269/\$15.00, AMC383270/\$15.00		- n/a -	60.00
2	4.00	LOCATABLE MINERALS / MINING CLAIMS- NEW,UNADJUD, ONE OR MORE AUTH NOS / NEW MINING CLAIM LOCATION FEE \$30 (1993) CASES: AMC383267/\$30.00, AMC383268/\$30.00, AMC383269/\$30.00, AMC383270/\$30.00		- n/a -	120.00
3	4.00	LOCATABLE MINERALS / MINING CLAIMS- NEW,UNADJUD, ONE OR MORE AUTH NOS / NEW MINING CLM MAINT FEE \$125 (1993) CASES: AMC383267/\$125.00, AMC383268/\$125.00, AMC383269/\$125.00, AMC383270/\$125.00	MAINT 2007 (4)	- n/a -	500.00
TOTAL:					\$680.00

PAYMENT INFORMATION	
1	AMOUNT: \$680.00
	POSTMARKED: 5/25/07 0:00
	TYPE: CHECK
	RECEIVED: 05/30/2007
	CHECK NO: 9654
	NAME: MYERS, PETER D 2207 CRESCENT DR DODGE CITY KS 67801

REMARKS

This receipt was generated by the automated BLM Collections and Billing System and is a paper representation of a portion of the official electronic record contained therein.

NOTICE!!

These documents have been scanned!

Do not place un-scanned documents beneath this notice!

Do not remove this notice from this file!

GPO Jacket No. 560-102
Print Order 61540
Rise Business Services, LLC
Job=AZ15 5/28/2019



Box Number= AZ15090



Claim Begin-End: AMC383267-AMC383270

2 Correspondence



AZ15090-10

AMC381882-AMC383274



United States Department of the Interior



BUREAU OF LAND MANAGEMENT

Arizona State Office

One North Central Avenue, Suite 800

Phoenix, Arizona 85004-4427

www.blm.gov/az/

OCT 07 2016

In Reply Refer To:

3800 (9200) RM

AMC361755, AMC366532, AMC383267, *Amc361955*

CERTIFIED MAIL - RETURN RECEIPT REQUESTED No. 7016 1370 0001 2495 2882

DECISION

P M EXPL LLC; MYERS PETE : This decision affects those claims shown
2207 CRESCENT DR : on the attached list(s).
DODGE CITY, KS 67801-2827 :

SEE ENCLOSURE FOR LIST OF CLAIMS

MINING CLAIMS DECLARED FORFEIT

The mining claims listed above have been declared forfeit as of September 1, 2016, for failure to timely file the required maintenance fee payment or small miner's maintenance fee waiver (waiver).

Claimants are required to pay an annual non-refundable maintenance fee of \$155 per 20 acres or portion thereof, or submit a waiver, on or before September 1 of each year. These requirements were established by 30 U.S.C. 28f-1, as amended, and 43 CFR 3834 and 3835.

Our records do not show receipt of a maintenance fee payment or small miner waiver filed on or before the due date. Therefore, the claims listed above are forfeit.

Reclamation Requirements

This decision does not relieve you of the liability for reclamation of all areas disturbed by your activities on lands covered by the subject mining claim(s) and/or site(s). After you complete the reclamation, you must notify the authorized officer of the appropriate surface managing agency so that the authorized officer may conduct a final site inspection and determine whether you may be released from liability. If you fail to reclaim the land to the satisfaction of the authorized officer, the surface management agency may cite you for noncompliance under its surface management regulations. For land administered by the Bureau of Land Management (BLM), if you fail to

reclaim the land to the satisfaction of the authorized officer as required in 43 CFR Subpart 3809, BLM will issue an order of noncompliance under 43 CFR 3809.601(a). If you fail to comply with the non-compliance order, BLM may take further action under 43 CFR 3809.604. Failure to conduct reclamation is a prohibited act that may subject you to criminal penalties. See 43 CFR 3809.605(h) and 43 CFR 3809.700.

Appeal Procedures

This decision may be appealed to the Interior Board of Land Appeals, Office of the Secretary, in accordance with the regulations contained in 43 CFR, Part 4, and the enclosed Form 1842-1. If an appeal is taken, your notice of appeal must be filed in this office (at the above address) within 30 days from receipt of this decision. The appellant has the burden of showing that the decision appealed from is in error.

If you wish to file a petition pursuant to regulation 43 CFR 4.21 (58 FR 4939, January 19, 1993) for a stay of the effectiveness of this decision during the time that your appeal is being reviewed by the Board, the petition for a stay must accompany your notice of appeal. A petition for a stay is required to show sufficient justification based on the standards listed below. Copies of the notice of appeal and petition for a stay **must** also be submitted to each party named in this decision and to the Interior Board of Land Appeals and to the appropriate Office of the Solicitor (see 43 CFR 4.413) at the same time the original documents are filed with this office. If you request a stay, you have the burden of proof to demonstrate that a stay should be granted.

Standards for Obtaining a Stay

Except as otherwise provided by law or other pertinent regulation, a petition for a stay of a decision pending appeal shall show sufficient justification based on the following standards:

- (1) The relative harm to the parties if the stay is granted or denied,
- (2) The likelihood of the appellant's success on the merits,
- (3) The likelihood of immediate and irreparable harm if the stay is not granted, and
- (4) Whether the public interest favors granting the stay.

Please include your AMC serial number(s) on all correspondence. If additional information is required, please call RéAnn Myers at 602-417-9413.



Rebecca Heick
Deputy State Director
Lands, Minerals, and Energy Division

Enclosure

P M EXPL LLC; MYERS PETE
2207 CRESCENT DR
DODGE CITY KS 67801-2827

<u>LEAD FILE NUMBER</u>	<u>CLAIM NUMBER</u>	<u>CLAIM NAME</u>
AMC361755	AMC361756	N.D. #11
AMC361955	AMC361956	N.D.#13
AMC366532	AMC366532	KPD#001
AMC366532	AMC366533	KPD#004
AMC366532	AMC366534	KPD#005
AMC366532	AMC366535	KPD#006
AMC366532	AMC366537	KPD#009
AMC366532	AMC366539	KPD#015
AMC366532	AMC366542	KPD#018
AMC366532	AMC366543	KPD#019
AMC366532	AMC366545	KPD#021
AMC366532	AMC366546	KPD#022
AMC366532	AMC366547	KPD#023
AMC366532	AMC366548	KPD#024
AMC366532	AMC366549	KPD#025
AMC366532	AMC366550	KPD#026
AMC366532	AMC366551	KPD#027
AMC366532	AMC366552	KPD#034
AMC366532	AMC366554	KPD#043
AMC366532	AMC366555	KPD#048
AMC366532	AMC366556	KPD#057
AMC366532	AMC366557	KPD#060
AMC383267	AMC383267	KPD 010
AMC383267	AMC383268	KPD 011
AMC383267	AMC383270	KPD 030

SENDER: COMPLETE THIS SECTION

COMPLETE THIS SECTION ON DELIVERY

- Complete items 1, 2, and 3.
- Print your name and address on the reverse so that we can return the card to you.
- Attach this card to the back of the mailpiece, or on the front if space permits.

1. Article Addressed to:
 P M EXPL LLC; MYERS PETE
 2207 CRESCENT DR
 DODGE CITY KS 67801-2827
 920/RM/AMC361755, AMC366532,
 AMC383267



9590 9402 1825 6104 0397 51

2. Article Number (Transfer from service label)
 7016 1370 0001 2495 2882

PS Form 3811, July 2015 PSN 7530-02-000-9053

A. Signature
 X

B. Received by (Printed Name)
 Pete Myers

C. Date of Delivery
 OCT 17 2016
 67801

D. Is delivery address different from item 1? Yes
 If YES, enter delivery address below: No

3. Service Type

<input type="checkbox"/> Adult Signature	<input type="checkbox"/> Priority Mail Express®
<input type="checkbox"/> Adult Signature Restricted Delivery	<input type="checkbox"/> Registered Mail™
<input checked="" type="checkbox"/> Certified Mail®	<input type="checkbox"/> Registered Mail Restricted Delivery
<input type="checkbox"/> Certified Mail Restricted Delivery	<input type="checkbox"/> Return Receipt for Merchandise
<input type="checkbox"/> Collect on Delivery	<input checked="" type="checkbox"/> Signature Confirmation™
<input type="checkbox"/> Collect on Delivery Restricted Delivery	<input type="checkbox"/> Signature Confirmation Restricted Delivery
<input type="checkbox"/> All Restricted Delivery	

Domestic Return Receipt

USPS TRACKING #

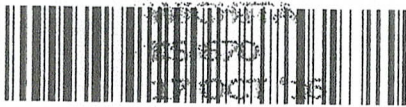

9590 9402 1825 6104 0397 51

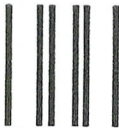

First-Class Mail
 Postage & Fees Paid
 USPS
 Permit No. G-10

United States Postal Service

RECEIVED
 BLM AZ STATE OFFICE
 2016 OCT 24 PM 2:14
 PHOENIX, ARIZONA

• Sender: Please print your name, address, and ZIP+4® in this box•

UNITED STATES
 DEPARTMENT OF THE INTERIOR
 Bureau of Land Management
 Arizona State Office
 One N. Central Avenue, Suite 800
 Phoenix, AZ 85004-4427

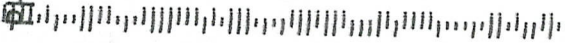

NOTICE!!

These documents have been scanned!

Do not place un-scanned documents beneath this notice!

Do not remove this notice from this file!

GPO Jacket No. 560-102
Print Order 61540
Rise Business Services, LLC
Job=AZ15 5/28/2019



Box Number= AZ15090



Claim Begin-End: AMC383267-AMC383270

3 Transfers



AZ15090-10

AMC381882-AMC383274

**NO
DOCUMENTS
FOUND**

NO DOCUMENTS FOUND
NO DOCUMENTS FOUND

NOTICE!!

These documents have been scanned!

Do not place un-scanned documents beneath this notice!

Do not remove this notice from this file!

GPO Jacket No. 560-102
Print Order 61540
Rise Business Services, LLC
Job=AZ15 5/28/2019



Box Number= AZ15090



Claim Begin-End: AMC383267-AMC383270

4 Annual Filings



AZ15090-10

AMC381882-AMC383274

Notice Of Intention To Hold Mining Claim(s)

361755
361955
366532
383267

This Notice of Intention to Hold Mining Claim(s) is made pursuant to 43 C.F.R., subpart 3833.2.3, by:

Name (owner or agent) P.M. EXPLORATION LLC

Address 2207 CRESCENT DRIVE

City, State, Zip DODGE CITY, KS. 67801

Claim Name	BLM AMC#	Cochise County Recording #
<u>N.D.#10</u>	<u>AMC361755</u>	<u>040617412</u>
<u>N.D.#12</u>	<u>AMC361955</u>	<u>040620541</u>
<u>KPD#008</u>	<u>AMC366536</u>	<u>050725419</u>
<u>KPD#012</u>	<u>AMC366538</u>	<u>050725420</u>
<u>KPD#016</u>	<u>AMC366540</u>	<u>050725422</u>
<u>KPD#017</u>	<u>AMC366541</u>	<u>050725423</u>
<u>KPD#020</u>	<u>AMC366544</u>	<u>050725426</u>
<u>KPD#029</u>	<u>AMC383269</u>	<u>070517896</u>
<u>KPD#035</u>	<u>AMC366553</u>	<u>050725435</u>

RECEIVED
BLM AZ STATE OFFICE
2018 AUG 29 P 2:32
PHOENIX, ARIZONA

The above named claim(s) is (are) held claimed by the owner(s) for the valuable mineral contained therein. I (we) intend to continue development of the claim(s).

Annual assessment work or report of geological, geochemical or geophysical survey is not required because the owner has paid a rental fee of \$155.00 per claim for the assessment year ending August 31, 2018 and is paying \$155.00 per claim for an advanced rental fee for the assessment work for the year beginning on September 1, 2018.

Signed [Signature]

Date 8-28-18

ENTERED
SEP 05 2018
BY: RSM

4251546

PRESS FIRMLY TO SEAL

PRESS FIRMLY TO SEAL



1007



85004

U.S. POSTAGE PAID
1-Day
DODGE CITY, KS
67801
AUG 28, 18
AMOUNT

\$24.70
R2304M114140-04

PRIORITY ★ MAIL ★ EXPRESS™

OUR FASTEST SERVICE IN THE U.S.

RECEIVED
M AZ STATE OFFICE
AUG 29 P 2:32
PHOENIX, ARIZONA

WHEN USED INTERNATIONALLY,
A CUSTOMS DECLARATION
LABEL MAY BE REQUIRED.



EP13F July 2013 OD: 12.5 x 9.5



PS 10001000006

WRITE FIRMLY WITH BALL POINT PEN ON HARD SURFACE TO MAKE ALL COPIES LEGIBLE.

CUSTOMER USE ONLY

FROM: (PLEASE PRINT) _____ PHONE () _____

PAYMENT BY ACCOUNT (if applicable)

DELIVERY OPTIONS (Customer Use Only)

SIGNATURE REQUIRED Note: The mailer must check the "Signature Required" box if the mailer: 1) Requires the addressee's signature; OR 2) Purchases additional insurance; OR 3) Purchases COD service; OR 4) Purchases Return Receipt service. If the box is not checked, the Postal Service will leave the item in the addressee's mail receptacle or other secure location without attempting to obtain the addressee's signature on delivery.

Delivery Options

No Saturday Delivery (delivered next business day)
 Sunday/Holiday Delivery Required (additional fee, where available)
 10:30 AM Delivery Required (additional fee, where available)
 *Refer to USPS.com® or local Post Office™ for availability.

TO: (PLEASE PRINT) _____ PHONE () _____

ZIP + 4® (U.S. ADDRESSES ONLY)

- For pickup or USPS Tracking™, visit USPS.com or call 800-222-1811.
- \$100.00 insurance included.



EE180311364US

EE180311364US



ORIGIN (POSTAL SERVICE USE ONLY)

1-Day 2-Day Military DPO

PO ZIP Code	Scheduled Delivery Date (MM/DD/YY)	Postage	
		\$	
Date Accepted (MM/DD/YY)	Scheduled Delivery Time	Insurance Fee	COD Fee
	<input type="checkbox"/> 10:30 AM <input type="checkbox"/> 9:00 PM <input type="checkbox"/> 12 NOON	\$	\$
Time Accepted	10:30 AM Delivery Fee	Return Receipt Fee	Live Aerial Transportation Fee
<input type="checkbox"/> AM <input type="checkbox"/> PM	\$	\$	\$
Special Handling/Fragile	Sunday/Holiday Premium Fee	Total Postage & Fees	
\$	\$	\$	
Weight	<input type="checkbox"/> Flat Rate	Acceptance Employee Initials	
lbs. ozs.			

DELIVERY (POSTAL SERVICE USE ONLY)

Delivery Attempt (MM/DD/YY)	Time	Employee Signature
	<input type="checkbox"/> AM <input type="checkbox"/> PM	
Delivery Attempt (MM/DD/YY)	Time	Employee Signature
	<input type="checkbox"/> AM <input type="checkbox"/> PM	

LABEL 11-B, OCTOBER 2016 PSN 7690-02-000-9996 3-ADDRESSEE COPY

VISIT US AT USPS.COM®
ORDER FREE SUPPLIES ONLINE



This envelope is made from post-consumer waste. Please recycle - again.

This packaging is the property of the U.S. Postal Service® and is provided solely for use in sending Priority Mail Express™ shipments. Misuse may be a violation of federal law. This packaging is not for resale. EPI3F © U.S. Postal Service; July 2013; All rights reserved.

United States Department of the Interior
Bureau of Land Management
 DIV OF LANDS, MINRLS & ENERGY
 ONE N CENTRAL AVE
 PHOENIX, AZ 85004 -4427
 Phone: 602-417-9200

Receipt

No: 4251546

Transaction #: 4367058	
Date of Transaction: 08/31/2018	
CUSTOMER:	
PETER D MYERS 2207 CRESCENT DR DODGE CITY,KS 67801-2827 US	

LINE #	QTY	DESCRIPTION	REMARKS	UNIT PRICE	TOTAL
1	1.00	LOCATABLE MINERALS / MINING CLAIMS- NOT NEW-UNADJUD, ONE AUTH NO. ONLY / MINING CLAIM MONEY RECEIVED CASES: AMC361755/\$1395.00	MAINT 2019/1395	- n/a -	1395.00
TOTAL:					\$1,395.00

PAYMENT INFORMATION			
1	AMOUNT:	1395.00	POSTMARKED: N/A
	TYPE:	CHECK	RECEIVED: 08/29/2018
	CHECK NO:	4611	
	NAME:	MYERS, PETER D 2207 CRESCENT DR DODGE CITY KS 67801-2827 US	

REMARKS

This receipt was generated by the automated BLM Collections and Billing System and is a paper representation of a portion of the official electronic record contained therein.

361755
361955
366532

Notice Of Intention To Hold Mining Claim(s)

This Notice of Intention to Hold Mining Claim(s) is made pursuant to 43 C.F.R., subpart 3833.2.3, by:

Name (owner or agent) P.M. EXPLORATION LLC

Address 2207 CRESCENT DRIVE

City, State, Zip DODGE CITY, KS. 67801

RECEIVED
BLM AZ STATE OFFICE
2017 AUG 22 A 1:34
PHOENIX, ARIZONA

Claim Name	BLM AMC#	Cochise County Recording #
<u>N.D.#10</u>	<u>AMC361755</u>	<u>040617412</u>
<u>N.D.#12</u>	<u>AMC361955</u>	<u>040620541</u>
<u>KPD#008</u>	<u>AMC366536</u>	<u>050725419</u>
<u>KPD#012</u>	<u>AMC366538</u>	<u>050725420</u>
<u>KPD#016</u>	<u>AMC366540</u>	<u>050725422</u>
<u>KPD#017</u>	<u>AMC366541</u>	<u>050725423</u>
<u>KPD#020</u>	<u>AMC366544</u>	<u>050725426</u>
<u>KPD#029</u>	<u>AMC383269</u>	<u>070517896</u>
<u>KPD#035</u>	<u>AMC366553</u>	<u>050725435</u>

383267

The above named claim(s) is (are) held claimed by the owner(s) for the valuable mineral contained therein. I (we) intend to continue development of the claim(s).

Annual assessment work or report of geological, geochemical or geophysical survey is not required because the owner has paid a rental fee of \$155.00 per claim for the assessment year ending August 31, 2017 and is paying \$155.00 per claim for an advanced rental fee for the assessment work for the year beginning on September 1, 2017.

Signed [Signature]

Date 7-16-17

3949897

ENTERED
AUG 24 2017
BY: Rami

United States Department of the Interior
Bureau of Land Management
 DIV OF LANDS, MINRLS & ENERGY
 ONE N CENTRAL AVE
 PHOENIX, AZ 85004 -4427
 Phone: 602-417-9200

Receipt

No: 3949897

Transaction #: 4059625	
Date of Transaction: 08/22/2017	
CUSTOMER:	
PETER D MYERS 2207 CRESCENT DR DODGE CITY,KS 67801-2827 US	

LINE #	QTY	DESCRIPTION	REMARKS	UNIT PRICE	TOTAL
1	1.00	LOCATABLE MINERALS / MINING CLAIMS- NOT NEW-UNADJUD,ONE AUTH NO. ONLY / MINING CLAIM MONEY RECEIVED CASES: AMC361755/\$1485.00	MAINT 2018/9	- n/a -	1485.00
TOTAL:					\$1,485.00

PAYMENT INFORMATION			
1	AMOUNT:	1485.00	POSTMARKED: 08/17/2017
	TYPE:	CHECK	RECEIVED: 08/22/2017
	CHECK NO:	4216	
	NAME:	MYERS, PETER D 2207 CRESCENT DR DODGE CITY KS 67801-2827 US	

REMARKS

This receipt was generated by the automated BLM Collections and Billing System and is a paper representation of a portion of the official electronic record contained therein.

Notice Of Intention To Hold Mining Claim(s)

361755
361955
366532
383267

This Notice of Intention to Hold Mining Claim(s) is made pursuant to 43 C.F.R., subpart 3833.2.3, by:

RECEIVED
BLM AZ STATE OFFICE

Name (owner or agent) P.M. EXPLORATION LLC

2016 AUG 30 P 1:59

Address 2207 CRESCENT DRIVE

PHOENIX, ARIZONA

City, State, Zip DODGE CITY, KS. 67801

Claim Name	BLM AMC#	Cochise County Recording #
<u>N.D.#10</u>	<u>AMC361755</u>	<u>040617412</u>
<u>N.D.#12</u>	<u>AMC361955</u>	<u>040620541</u>
<u>KPD#008</u>	<u>AMC366536</u>	<u>050725419</u>
<u>KPD#012</u>	<u>AMC366538</u>	<u>050725420</u>
<u>KPD#016</u>	<u>AMC366540</u>	<u>050725422</u>
<u>KPD#017</u>	<u>AMC366541</u>	<u>050725423</u>
<u>KPD#020</u>	<u>AMC366544</u>	<u>050725426</u>
<u>KPD#029</u>	<u>AMC383269</u>	<u>070517896</u>
<u>KPD#035</u>	<u>AMC366553</u>	<u>050725435</u>

The above named claim(s) is (are) held claimed by the owner(s) for the valuable mineral contained therein. I (we) intend to continue development of the claim(s).

Annual assessment work or report of geological, geochemical or geophysical survey is not required because the owner has paid a rental fee of \$155.00 per claim for the assessment year ending August 31, 2016 and is paying \$155.00 per claim for an advanced rental fee for the assessment work for the year beginning on September 1, 2016. Owner further states that mineral production activities have occurred upon the claims during the last assessment year that would normally qualify as annual assessment work.

Signed [Signature] 8-26-16

SEP 01 2016
BY: [Signature]

RECEIPT # 3647704

8-26-16

Please record this

MDL

Call me if you have any questions.

Thank you,

Pete Myers

2207 Crescent Dr

Dodge City, KS

620-430-3780

67801

PHOENIX, ARIZONA

2011 AUG 30 P 1:59

RECEIVED
ALMAY STATE OFFICE

Peter Myers
2207 Cresent Dr.
Dodge City, Ks.
67801

CERTIFIED MAIL

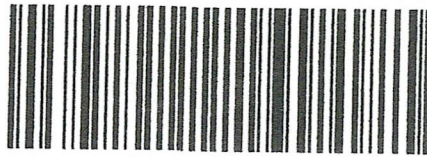

7016 0600 0000 2895 2446



1000



85004

U.S. POSTAGE
PAID
DODGE CITY, KS
67801
AUG 26, 16
AMOUNT
\$6.47
R2305H128754-13

BLM AZ STATE OFFICE

2016 AUG 30 P 1:59

PHOENIX, ARIZONA

Bureau of Land Management
Arizona St. Office
One N. Central Ave.
Phoenix, AZ 85004

8500494427 0041

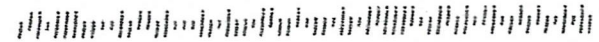

United States Department of the Interior
Bureau of Land Management
 DIV OF LANDS, MINRLS & ENERGY
 ONE N CENTRAL AVE
 PHOENIX, AZ 85004 -4427
 Phone: 602-417-9200

Receipt

No: 3647704

Transaction #: 3751693	
Date of Transaction: 08/31/2016	
CUSTOMER:	
PETER D MYERS 2207 CRESCENT DR DODGE CITY,KS 67801-2827 US	

LINE #	QTY	DESCRIPTION	REMARKS	UNIT PRICE	TOTAL
1	1.00	LOCATABLE MINERALS / MINING CLAIMS- NOT NEW-UNADJUD,ONE AUTH NO. ONLY / MINING CLAIM MONEY RECEIVED CASES: AMC361755/\$1395.00	NOI/MAINT FEE 2017 - 9	- n/a -	1395.00
TOTAL:					\$1,395.00

PAYMENT INFORMATION					
1	AMOUNT:	1395.00	POSTMARKED:	08/26/2016	
	TYPE:	CHECK	RECEIVED:	08/30/2016	
	CHECK NO:	4194			
	NAME:	MYERS, PETER D 2207 CRESCENT DR DODGE CITY KS 67801-2827 US			

REMARKS

This receipt was generated by the automated BLM Collections and Billing System and is a paper representation of a portion of the official electronic record contained therein.

8-26-15
AMC 361755
361955
366532
38B267

B.L.M.,

Please record this
Mining Claims."

RECEIVED
BLM, AZ
2015 AUG 14 4:07
PHOENIX, ARIZONA

Notice of Intention

Enclosed \$5,270 for 34 claims

Call if you have any questions. 620-430-3188
RM

Ripon

NOTIFIED OF INCORRECT AMC # BY MAIL.
1007 15 BR

Notice Of Intention To Hold Mining Claim(s)

This Notice of Intention to Hold Mining Claim(s) is made pursuant to 43 C.F.R., subpart 3833.2.3, by:

Name (owner or agent) P.M. EXPLORATION LLC

Address 2207 CRESCENT DRIVE

City, State, Zip DODGE CITY, KS. 67801

Claim Name	BLM AMC#	Cochise County Recording #
<u>KPD#001</u>	<u>AMC366532</u>	<u>050725415</u>
<u>KPD#004</u>	<u>AMC366533</u>	<u>050725416</u>
<u>KPD#005</u>	<u>AMC366534</u>	<u>050725417</u>
<u>KPD#006</u>	<u>AMC366535</u>	<u>050725418</u>
<u>KPD#008</u>	<u>AMC366536</u>	<u>050725419</u>
<u>KPD#009</u>	<u>AMC366537</u>	<u>050725419</u>
<u>KPD#010</u>	<u>AMC383267</u>	<u>070517894</u>
<u>KPD#011</u>	<u>AMC383268</u>	<u>070517895</u>

ADDITIONAL CLAIMS ARE LISTED ON ATTACHED SHEET

The above named claim(s) is (are) held claimed by the owner(s) for the valuable mineral contained therein. I (we) intend to continue development of the claim(s).

Annual assessment work or report of geological, geochemical or geophysical survey is not required because the owner has paid a rental fee of \$155.00 per claim for the assessment year ending August 31, 2015 and is paying \$155.00 per claim for an advanced rental fee for the assessment work for the year beginning on September 1, 2015. Owner further states that mineral production, activities have occurred upon the claims during the last assessment year that would normally qualify as annual assessment work.

Signed [Signature]

Date 8-26-15

RECEIVED
LM & MINING OFFICE
PHOENIX, ARIZONA
AUG 31 P 4: 07

RECEIPT # 338 3814

Claim Name	Owner	BLM AMC #	Cochise County Recording #	Claim Type
KPD 012	PM Exploration LLC	366538	050725420	Lode
KPD 015	PM Exploration LLC	366539	050725421	Lode
KPD 016	PM Exploration LLC	366540	050725422	Lode
KPD 017	PM Exploration LLC	366541	050725423	Lode
KPD 018	PM Exploration LLC	366542	050725424	Lode
KPD 019	PM Exploration LLC	366543	050725425	Lode
KPD 020	PM Exploration LLC	366544	050725426	Lode
KPD 021	PM Exploration LLC	366545	050725427	Lode
KPD 022	PM Exploration LLC	366546	050725428	Lode
KPD 023	PM Exploration LLC	366547	050725429	Lode
KPD 024	PM Exploration LLC	366548	050725430	Lode
KPD 025	PM Exploration LLC	366549	050725431	Lode
KPD 026	PM Exploration LLC	366550	050725432	Lode
KPD 027	PM Exploration LLC	366551	050725433	Lode
KPD 029	PM Exploration LLC	383269	050717896	Lode
KPD 030	PM Exploration LLC	383270	050717897	Lode
KPD 034	PM Exploration LLC	366552	050725434	Lode
KPD 035	PM Exploration LLC	366553	050725435	Lode
KPD 043	PM Exploration LLC	366554	050725436	Lode
KPD 048	PM Exploration LLC	366555	050725437	Lode
KPD 057	PM Exploration LLC	366556	050725438	Lode
KPD 060	PM Exploration LLC	366557	050725439	Lode
N.D. 10	PM Exploration LLC	361755	040617412	Lode
N.D. 11	PM Exploration LLC	361756	040617413	Lode
N.D. 12	PM Exploration LLC	361757	040617414	Lode
N.D. 13	PM Exploration LLC	361758	040617415	Lode

361955
~~361954~~
361956

Pat Meyer 8-26-15

RECEIVED
BLM ARIZONA
2015 AUG 31 P 4: 07
PHOENIX, ARIZONA

United States Department of the Interior
Bureau of Land Management
 LANDS/RECREATION & PLANNING
 ONE N CENTRAL AVE
 PHOENIX, AZ 85004 -2203
 Phone: 602-417-9200

Receipt

No: 3383814

Transaction #: 3482135	
Date of Transaction: 09/01/2015	
CUSTOMER:	
PETER D MYERS 2207 CRESCENT DR DODGE CITY,KS 67801-2827 US	

LINE #	QTY	DESCRIPTION	REMARKS	UNIT PRICE	TOTAL
1	1.00	LOCATABLE MINERALS / MINING CLAIMS-NOT NEW-UNADJUD,ONE AUTH NO. ONLY / MINING CLAIM MONEY RECEIVED CASES: AMC366532/\$5270.00	NOI / MAINT FEE PYMNT - 34 2016	- n/a -	5270.00
TOTAL:					\$5,270.00

PAYMENT INFORMATION					
1	AMOUNT:	5270.00	POSTMARKED:	08/26/2015	
	TYPE:	CHECK	RECEIVED:	08/31/2015	
	CHECK NO:	3880			
	NAME:	MYERS, PETER D 2207 CRESCENT DR DODGE CITY KS 67801-2827 US			

REMARKS

This receipt was generated by the automated BLM Collections and Billing System and is a paper representation of a portion of the official electronic record contained therein.

Ran

DEPARTMENT OF THE INTERIOR
BUREAU OF LAND MANAGEMENT
MINING CLAIMS

MC Customer Information - With Serial No. and Claim Name
ACTIVE CLAIMS

Admin State: AZ

Geo State: AZ

MYERS PETE
 2207 CRESCENT DR
 DODGE CITY, KS 67801-2827

CUSTOMER ID: 2218402

<u>Serial No.</u>	<u>Claim Name/Number</u>	<u>Lead Serial No.</u>	<u>Disposition</u>
AMC361755	N.D. #10	AMC361755	ACTIVE
AMC361756	N.D. #11	AMC361755	ACTIVE
AMC366532	KPD#001	AMC366532	ACTIVE
AMC366533	KPD#004	AMC366532	ACTIVE
AMC366534	KPD#005	AMC366532	ACTIVE
AMC366535	KPD#006	AMC366532	ACTIVE
AMC366536	KPD#008	AMC366532	ACTIVE
AMC366537	KPD#009	AMC366532	ACTIVE
AMC366538	KPD#012	AMC366532	ACTIVE
AMC366539	KPD#015	AMC366532	ACTIVE
AMC366540	KPD#016	AMC366532	ACTIVE
AMC366541	KPD#017	AMC366532	ACTIVE
AMC366542	KPD#018	AMC366532	ACTIVE
AMC366543	KPD#019	AMC366532	ACTIVE
AMC366544	KPD#020	AMC366532	ACTIVE
AMC366545	KPD#021	AMC366532	ACTIVE
AMC366546	KPD#022	AMC366532	ACTIVE
AMC366547	KPD#023	AMC366532	ACTIVE
AMC366548	KPD#024	AMC366532	ACTIVE
AMC366549	KPD#025	AMC366532	ACTIVE
AMC366550	KPD#026	AMC366532	ACTIVE
AMC366551	KPD#027	AMC366532	ACTIVE
AMC366552	KPD#034	AMC366532	ACTIVE
AMC366553	KPD#035	AMC366532	ACTIVE
AMC366554	KPD#043	AMC366532	ACTIVE
AMC366555	KPD#048	AMC366532	ACTIVE
AMC366556	KPD#057	AMC366532	ACTIVE
AMC366557	KPD#060	AMC366532	ACTIVE
AMC383267	KPD 010	AMC383267	ACTIVE
AMC383268	KPD 011	AMC383267	ACTIVE
AMC383269	KPD 029	AMC383267	ACTIVE
AMC383270	KPD 030	AMC383267	ACTIVE

Number of ACTIVE cases: 32

UNITED STATES DEPARTMENT OF INTERIOR
BUREAU OF LAND MANAGEMENT

CLAIM NAME/NUMBER INDEX

County: COCHISE

<u>Claim Name/Number</u>	<u>Serial Number</u>	<u>Claimant(s)</u>	<u>Mer</u>	<u>Twn</u>	<u>Range</u>	<u>Sec</u>	<u>Subdiv</u>	<u>Location Date</u>	<u>Case Closed</u>
N.D. #10	AMC361755	MYERS PETE	14	0230S	0200E	030	SW	05/24/2004	
			14	0230S	0200E	031	NW	05/24/2004	
		P M EXPL LLC	14	0230S	0200E	030	SW	05/24/2004	
			14	0230S	0200E	031	NW	05/24/2004	
N.D. #11	AMC361756	MYERS PETE	14	0230S	0200E	030	SW	05/24/2004	
			14	0230S	0200E	031	NW	05/24/2004	
		P M EXPL LLC	14	0230S	0200E	030	SW	05/24/2004	
			14	0230S	0200E	031	NW	05/24/2004	
N.D.#12 N.D.#13	AMC361955 AMC361956		14	0230S	0200E	030	SW	06/23/2004	
			14	0230S	0200E	030	SW	06/23/2004	

Pete Myers
2207 Crescent Dr
Dodge City, KS

2015 AUG 31 P 3:58
RECEIVED
RETURN RECEIPT
REQUESTED

CERTIFIED MAIL

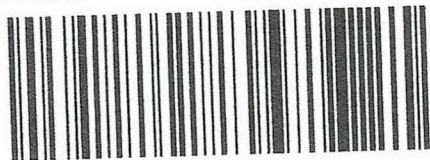

7015 0640 0003 7395 3890



1000



85004

U.S. POSTAGE
PAID
DODGE CITY, KS
67801
AUG 26, 15
AMOUNT
\$6.74
R2304M115131-11

BLM
AZ State Office
1 North Central Ave, Suite 800
Phoenix, AZ 85004

9500494427

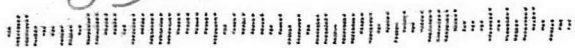

8-27-14

B.Z.M.,

Please record this
for P.M. Ex.

Call if you have any
questions. 620 430 3188

Thanks,

Pete Meyer

PHOENIX, ARIZONA

2014 AUG 29 P 1:26

RECEIVED
BLM AZ STATE OFFICE

361755

361955

366532

383267

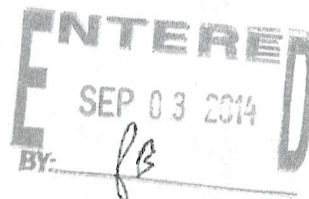

Notice Of Intention To Hold Mining Claim(s)

This Notice of Intention to Hold Mining Claim(s) is made pursuant to 43 C.F.R., subpart 3833.2.3, by:

Name (owner or agent) P.M. EXPLORATION LLC

Address 2207 CRESCENT DRIVE

City, State, Zip DODGE CITY, KS. 67801

Claim Name	BLM AMC#	Cochise County Recording #
<u>KPD#001</u>	<u>AMC366532</u> ↘	<u>050725415</u>
<u>KPD#004</u>	<u>AMC366533</u>	<u>050725416</u>
<u>KPD#005</u>	<u>AMC366534</u>	<u>050725417</u>
<u>KPD#006</u>	<u>AMC366535</u>	<u>050725418</u>
<u>KPD#008</u>	<u>AMC366536</u>	<u>050725419</u>
<u>KPD#009</u>	<u>AMC366537</u> ↗	<u>050725419</u>
<u>KPD#010</u>	<u>AMC383267</u> ↘	<u>070517894</u>
<u>KPD#011</u>	<u>AMC383268</u> ↘	<u>070517895</u>

RECEIVED
 BLM AZ STATE OFFICE
 2014 AUG 29 P 1:27
 PHOENIX ARIZONA

ADDITIONAL CLAIMS ARE LISTED ON ATTACHED SHEET

The above named claim(s) is (are) held claimed by the owner(s) for the valuable mineral contained therein. I (we) intend to continue development of the claim(s).

Annual assessment work or report of geological, geochemical or geophysical survey is not required because the owner has paid a rental fee of \$155.00 per claim for the assessment year ending August 31, 2014 and is paying \$155.00 per claim for an advanced rental fee for the assessment work for the year beginning on September 1, 2014. Owner further states that mineral production activities have occurred upon the claims during the last assessment year that would normally qualify as annual assessment work.

Signed Pete Myers

Date 8-27-14

NO. OF CLAIMS 34
 AMOUNT \$5270.00
 RECEIPT NO. 3119285
 INIT. Al.A.
 ** BLM-ASO**

ADDITIONAL CLAIMS FOR P.M. EXPLORATION LLC

Notice of Intention To Hold Mining Claims

Claim Name	BLM AMC#	Cochise Co. Recording #
KPD#012	AMC366538	050725420
KPD#015	AMC366539	050725421
KPD#016	AMC366540	050725422
KPD#017	AMC366541	050725423
KPD#018	AMC366542	050725424
KPD#019	AMC366543	050725425
KPD#020	AMC366544	050725426
KPD#021	AMC366545	050725427
KPD#022	AMC366546	050725428
KPD#023	AMC366547	050725429
KPD#024	AMC366548	050725430
KPD#025	AMC366549	050725431
KPD#026	AMC366550	050725432
KPD#027	AMC366551	050725433
KPD#029	AMC383269	070517896
KPD#030	AMC383270	070517897
KPD#034	AMC366552	050725434
KPD#035	AMC366553	050725435
KPD#043	AMC366554	050725436
KPD#048	AMC366555	050725437
KPD#057	AMC366556	050725438
KPD#060	AMC366557	050725439
N.D.#10	AMC361755	040617412
N.D.#11	AMC361756	040617413
N.D.#12	AMC361955	040620541
N.D.#13	AMC361956	040620540

RECEIVED
BLM AZ STATE OFFICE
2014 AUG 29 P 1:27
PHOENIX, ARIZONA

Signed

Peter Myers

Date

8-27-14

ENTERED INTO COMPUTER

Pete Myers
2207 Crescent Dr.
Dodge City, KS
167801

B.L.M.
One North Central Ave Suite 800
Phoenix, AZ 85004-4427

PHOENIX, ARIZONA

2014 AUG 29 P 1:28

RECEIVED
BLM AZ STATE OFFICE

United States Department of the Interior
Bureau of Land Management
LANDS/RECREATION & PLANNING
ONE N CENTRAL AVE
PHOENIX, AZ 85004 -2203
Phone: 602-417-9200

Receipt

No: 3119285

Transaction #: 3211094	
Date of Transaction: 09/02/2014	
CUSTOMER: ENTERED INTO COMPUTER	
PETER D MYERS 2207 CRESCENT DR DODGE CITY,KS 67801-2827 US	SEP - 3 2014 <i>fb</i>

LINE #	QTY	DESCRIPTION	REMARKS	UNIT PRICE	TOTAL
1	1.00	LOCATABLE MINERALS / MINING CLAIMS-NOT NEW-UNADJUD,ONE AUTH NO. ONLY / MINING CLAIM MONEY RECEIVED CASES: AMC366532/\$5270.00	MAINT FEE PYMNT (34)✓ 2015	- n/a -	5270.00
TOTAL:					\$5,270.00

PAYMENT INFORMATION					
1	AMOUNT:	5270.00	POSTMARKED:	08/28/2014	
	TYPE:	CHECK	RECEIVED:	08/29/2014	
	CHECK NO:	3790			
	NAME:	MYERS, PETER D 2207 CRESCENT DR DODGE CITY KS 67801-2827 US			

REMARKS	

This receipt was generated by the automated BLM Collections and Billing System and is a paper representation of a portion of the official electronic record contained therein.

PRESS FIRMLY TO SEAL

PRESS FIRMLY TO SEAL



1007

U.S. POSTAGE
PAID
ADDRESSEE CITY, KS
67801
AUG 28, 14
AMOUNT
\$19.99
00020342-09

PRIORITY ★ MAIL ★ EXPRESS™

OUR FASTEST SERVICE IN THE U.S.

RECEIVED
BLM AZ STATE OFFICE
2014 AUG 29 P 1:21
PHOENIX, ARIZONA

WHEN USED INTERNATIONALLY,
A CUSTOMS DECLARATION
LABEL MAY BE REQUIRED.



EP13F July 2013 OD: 12.5 x 9.5



PS10001000006

VISIT US AT **USPS.COM**®
ORDER FREE SUPPLIES ONLINE



EK342251192US

NATIONAL IISF



PRIORITY
★ MAIL ★
EXPRESS™

CUSTOMER USE ONLY

FROM: (PLEASE PRINT) **PHONE:** (620) 420-2188
John Myers
2207 Croscorn Dr
Dodge City, KS 67801

PAYMENT BY ACCOUNT (if applicable)

DELIVERY OPTIONS (Customer Use Only)

SIGNATURE REQUIRED Note: The mailer must check the "Signature Required" box if the mailer: 1) Requires the addressee's signature; OR 2) Purchases additional insurance; OR 3) Purchases CDS service; OR 4) Purchases Return Receipt service. If the box is not checked, the Postal Service will leave the item at the addressee's mail receptacle or other secure location without attempting to obtain the addressee's signature on delivery.

Delivery Options:

No Saturday Delivery (delivered next business day)
 Sunday/Holiday Delivery Required (additional fee, where available)
 10:30 AM Delivery Required (additional fee, where available)
*Refer to USPS.com or local Post Office for availability.

TO: (PLEASE PRINT) **PHONE:** ()
B.L.M.
One North Central Ave Suite 800
Phoenix, AZ

ZIP - 4* (U.S. ADDRESSES ONLY)
85004-4427

■ For pickup or USPS Tracking™, visit USPS.com or call 800-222-1811.
 ■ \$100.00 Insurance Included.

ORIGIN (POSTAL SERVICE USE ONLY)

1-Day 2-Day Military GPO

Post ZIP Code 67801	Scheduled Delivery Date (MM/DD/YYYY) 8/29/14	Postage \$ 19.99
Post Accepted (MM/DD/YYYY) 8/29/14	Scheduled Delivery Time <input type="checkbox"/> 10:30 AM <input checked="" type="checkbox"/> 3:00 PM <input type="checkbox"/> 12 NOON	Insurance Fee \$
This Accepted <input type="checkbox"/> AM <input checked="" type="checkbox"/> PM	10:30 AM Delivery Fee \$	Return Receipt Fee \$
Weight lb: oz:	Sunday/Holiday Premium Fee \$	Ins Animal Transportation Fee \$
Acceptance Employee Initials [Signature]	Total Postage & Fees \$ 19.99	

DELIVERY (POSTAL SERVICE USE ONLY)

Delivery Attempt (MM/DD/YYYY)	Time <input type="checkbox"/> AM <input type="checkbox"/> PM	Employee Signature
Delivery Attempt (MM/DD/YYYY)	Time <input type="checkbox"/> AM <input type="checkbox"/> PM	Employee Signature

LABEL 11-B, JANUARY 2014

PSN 7690-02-000-9996

3-ADDRESSEE COPY

This envelope is made from post-consumer waste. Please recycle - again.

This packaging is the property of the U.S. Postal Service® and is provided solely for use in sending Priority Mail Express™ shipments. Please reuse or recycle. This packaging is not for resale. EPI3F © U.S. Postal Service, July 2013. All rights reserved.



AMC366532
383267
 361755
 361955

Notice Of Intention To Hold Mining Claim(s)

This Notice of Intention to Hold Mining Claim(s) is made pursuant to 43 C.F.R., subpart 3833.2.3, by:

Name (owner or agent) P.M. EXPLORATION LLC

Address 2207 CRESCENT DRIVE

City, State, Zip DODGE CITY, KS. 67801

Claim Name	BLM AMC#	Cochise County Recording #
<u>KPD#001</u>	<u>AMC366532</u>	<u>050725415</u>
<u>KPD#004</u>	<u>AMC366533</u>	<u>050725416</u>
<u>KPD#005</u>	<u>AMC366534</u>	<u>050725417</u>
<u>KPD#006</u>	<u>AMC366535</u>	<u>050725418</u>
<u>KPD#008</u>	<u>AMC366536</u>	<u>050725419</u>
<u>KPD#009</u>	<u>AMC366537</u>	<u>050725419</u>
<u>KPD#010</u>	<u>AMC383267</u>	<u>070517894</u>
<u>KPD#011</u>	<u>AMC383268</u>	<u>070517895</u>

ADDITIONAL CLAIMS ARE LISTED ON ATTACHED SHEET

The above named claim(s) is (are) held claimed by the owner(s) for the valuable mineral contained therein. I (we) intend to continue development of the claim(s).

Annual assessment work or report of geological, geochemical or geophysical survey is not required because the owner has paid a rental fee of \$140.00 per claim for the assessment year ending August 31, 2013 and is paying \$140.00 per claim for an advanced rental fee for the assessment work for the year beginning on September 1, 2013. Owner further states that mineral production activities have occurred upon the claims during the last assessment year that would normally qualify as annual assessment work.

Signed [Signature]

Date 8-27-13

RECEIVED
 BLM AT STATE OFFICE
 A 10:09
 SEP 03 2013
 BY: TS

NO. OF CLAIMS 34
 AMOUNT \$4760.00
 RECEIPT NO. 2869918
 NIT. [Signature]

ADDITIONAL CLAIMS FOR P.M. EXPLORATION LLC

Notice of Intention to Hold Mining Claims

Claim Name	BLM AMC#	Cochise Co. Recording #
KPD#012	AMC366538	050725420
KPD#015	AMC366539	050725421
KPD#016	AMC366540	050725422
KPD#017	AMC366541	050725423
KPD#018	AMC366542	050725424
KPD#019	AMC366543	050725425
KPD#020	AMC366544	050725426
KPD#021	AMC366545	050725427
KPD#022	AMC366546	050725428
KPD#023	AMC366547	050725429
KPD#024	AMC366548	050725430
KPD#025	AMC366549	050725431
KPD#026	AMC366550	050725432
KPD#027	AMC366551	050725433
KPD#029	AMC383269	070517896
KPD#030	AMC383270	070517897
KPD#034	AMC366552	050725434
KPD#035	AMC366553	050725435
KPD#043	AMC366554	050725436
KPD#048	AMC366555	050725437
KPD#057	AMC366556	050725438
KPD#060	AMC366557	050725439
N.D.#10	AMC361755	040617412
N.D.#11	AMC361756	040617413
N.D.#12	AMC361955	040620541
N.D.#13	AMC361956	040620540

Signed

Peter M. ...

Date

8-27-13

RECEIVED
BLM AZ STATE OFFICE
2013 AUG 29 A 10:09
FLORENZA, ARIZONA

United States Department of the Interior
Bureau of Land Management
 LANDS/RECREATION & PLANNING
 ONE N CENTRAL AVE
 PHOENIX, AZ 85004 -2203
 Phone: 602-417-9200

Receipt

No: 2869918

Transaction #: 2955889	
Date of Transaction: 08/30/2013	
CUSTOMER:	
PETER D MYERS 2207 CRESCENT DR DODGE CITY,KS 67801-2827 US	

LINE #	QTY	DESCRIPTION	REMARKS	UNIT PRICE	TOTAL
1	1.00	LOCATABLE MINERALS / MINING CLAIMS-NOT NEW-UNADJUD,ONE AUTH NO. ONLY / MINING CLAIM MONEY RECEIVED CASES: AMC366532/\$4760.00	MAINT FEE PYMNT (34) 2014 / NOI (34) 2013	- n/a -	4760.00
TOTAL:					\$4,760.00

PAYMENT INFORMATION			
1	AMOUNT:	4760.00	POSTMARKED: 08/28/2013
	TYPE:	CHECK	RECEIVED: 08/29/2013
	CHECK NO:	3417	
	NAME:	MYERS, PETER D 2207 CRESCENT DR DODGE CITY KS 67801-2827 US	

REMARKS

This receipt was generated by the automated BLM Collections and Billing System and is a paper representation of a portion of the official electronic record contained therein.

DECONCINI MCDONALD YETWIN & LACY

A PROFESSIONAL CORPORATION
ATTORNEYS AT LAW

ROBIN E. BARNES, CP
rbarnes@dmyl.com

2525 EAST BROADWAY BOULEVARD • SUITE 200
TUCSON, ARIZONA 85716-5300
(520) 322-5000 • (520) 322-5585 (Fax)

WWW.DECONCINIMCDONALD.COM

AME 366532

383267

361755

August 23, 2012 361955

401295

406091

Via Federal Express

Arizona State Office
Bureau of Land Management
Attention: Public Room
One North Central Avenue, Suite 800
Phoenix, AZ 85004-4427

PHOENIX, ARIZONA

2012 AUG 24 A 9: 58

RECEIVED
BLM AZ STATE OFFICE

RE: **Payment of Claim Maintenance Fee; P.M. Exploration, LLC.**

Ladies and Gentlemen:

Delivered herewith is a check in the amount of \$14,000.00 as payment of the claim maintenance fees pursuant to the 30 U.S.C. § 28f(a), as adjusted by 30 U.S.C. § 28j(c) and implemented by notice in 74 *Federal Register* 30959-62 (June 29, 2009) and as amended by the Consolidated Appropriations Act 2012, Pub. L. No. 112-74, 125 Stat. 786 (2011). The owner has paid a maintenance fee of \$140 per for the assessment year beginning September 1, 2012. A copy of the Certification of Payment of Maintenance Fee in Lieu of Affidavit of Annual Assessment Work to be recorded with the Cochise County Recorder's Office is also enclosed herewith.

Please return a date-stamped copy of this letter and the affidavit along with the receipt for payment to this office.

Thank you for your assistance and please feel free to contact me or John Lacy with any questions or concerns.

Sincerely,

Robin E. Barnes, CP
Certified Paralegal

reb
Enc.
c. w/out enc. Peter Rees (via email)

NO. OF CLAIMS 100
AMOUNT 14000.00
RECEIPT NO. 2640796
INIT. R.E.

\\FILES\DOCS\STRA14\110776\LTR\MV1908.DOCX

ENTERED INTO COMPUTER

9/6/12 AT

Tucson

Phoenix

Flagstaff

Scottsdale

From: (520) 322-5000
Lu Ann Corliss
DeConcini Law Firm
2525 East Broadway
Suite 200
Tucson, AZ 85716

Origin ID: TUSA



Ship Date: 23AUG12
Act/Wgt: 1.0 LB
CAD: 5333594/INET3300

Delivery Address Bar Code



SHIP TO: (520) 322-5000
Arizona State Office
Bureau of Land Management
One North Central Ave., #800
Attn: Public Room
Phoenix, AZ 85004

BILL SENDER

Ref # 291366/110776/120165/251031/RB
Invoice #
PO #
Dept #

FRI - 24 AUG A1
PRIORITY OVERNIGHT

TRK# 7988 1472 2949

0201

XH ZSYA

85004
AZ-US
PHX

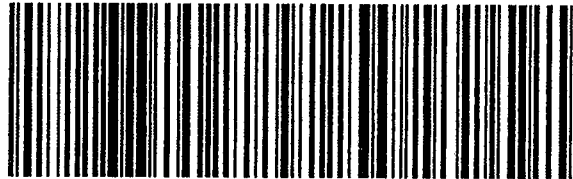
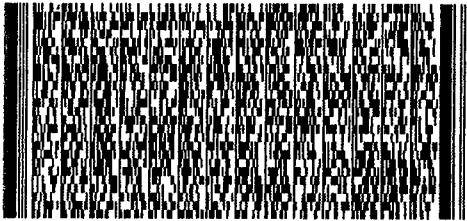

515G20C34/AA44

After printing this label:

1. Use the "Print" button on this page to print your label to your laser or inkjet printer.
2. Fold the printed page along the horizontal line.
3. Place label in shipping pouch and affix it to your shipment so that the barcode portion of the label can be read and scanned.

Warning: Use only the printed original label for shipping. Using a photocopy of this label for shipping purposes is fraudulent and could result in additional billing charges, along with the cancellation of your FedEx account number. Use of this system constitutes your agreement to the service conditions in the current FedEx Service Guide, available on fedex.com. FedEx will not be responsible for any claim in excess of \$100 per package, whether the result of loss, damage, delay, non-delivery, misdelivery, or misinformation, unless you declare a higher value, pay an additional charge, document your actual loss and file a timely claim. Limitations found in the current FedEx Service Guide apply. Your right to recover from FedEx for any loss, including intrinsic value of the package, loss of sales, income interest, profit, attorney's fees, costs, and other forms of damage whether direct, incidental, consequential, or special is limited to the greater of \$100 or the authorized declared value. Recovery cannot exceed actual documented loss. Maximum for items of extraordinary value is \$500, e.g. jewelry, precious metals, negotiable instruments and other items listed in our ServiceGuide. Written claims must be filed within strict time limits, see current FedEx Service Guide.

RECEIVED
BLMAZ STATE OFFICE
2012 AUG 24 A 9:58
PHOENIX, ARIZONA

After recording, please return to:
Marian C. LaLonde
DeConcini McDonald Yetwin & Lacy, P.C.
2525 E. Broadway Blvd., #200
Tucson, AZ 85716

RECEIVED
BLM AZ STATE OFFICE
2012 AUG 24 A 9:58
PHOENIX, ARIZONA

STATE OF ARIZONA)
) ss:
County of Pima)

CERTIFICATION OF PAYMENT OF MAINTENANCE FEE
IN LIEU OF AFFIDAVIT OF ANNUAL ASSESSMENT WORK

Marian C. LaLonde, being first duly sworn, deposes and says that:

1. She is an agent for P.M. Exploration, LLC, a Kansas limited liability company, the owner of the unpatented lode mining claims situated in Cochise County, Arizona (the "Claims"), the location notices of which are of record in Cochise County, and in the records of the Arizona State Office of the Bureau of Land Management under the file numbers indicated in the attached Exhibit A. The Claims are situated in Sections 25 and 36, Township 23 South, Range 19 East, Sections 1, Township 24 South, Range 19 East, Sections 30, 31, and 32, Township 23 South, Range 20 East, and Sections 5, 6, and 7, Township 24 South, Range 20 East, G&SR Mer.

2. Pursuant to the 30 U.S.C. § 28f(a), as adjusted by 30 U.S.C. § 28j(c) and implemented by notice in 74 *Federal Register* 30959-62 (June 29, 2009) and as amended by the Consolidated Appropriations Act 2012, Pub. L. No. 112-74, 125 Stat. 786 (2011), the owner has paid a maintenance fee of \$140 per for the assessment year beginning September 1, 2012. This Certificate is in lieu of an affidavit of performance of annual assessment work or notice of intent to hold.

3. The name and address of the owner of the Claims for which this Certificate is prepared are P.M. Exploration, LLC, 2207 Crescent Dr., Dodge City, KS 67801. THIS IS NOT A CHANGE OF ADDRESS

4. The Claims are held and claimed by the owner for the valuable minerals contained therein.

DATED this 23rd day of August, 2012.

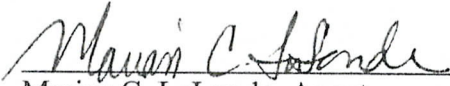
Marian C. LaLonde, Agent

Sworn and subscribed before me this 23rd day of August, 2012, by Marian C. LaLonde, agent for P.M. Exploration, LLC.

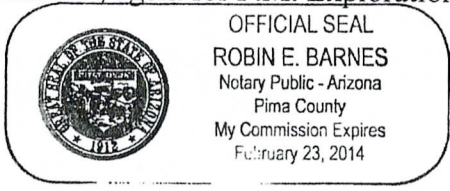



Notary Public

EXHIBIT A

CLAIM NAME	OWNER NAME	BLM AMC NO.	COCHISE COUNTY RECORDING INFO.
KPD #001	PM Exploration LLC	366532	2005-25415
KPD #004	PM Exploration LLC	366533	2005-25416
KPD #005	PM Exploration LLC	366534	2005-25417
KPD #006	PM Exploration LLC	366535	2005-25418
KPD #008	PM Exploration LLC	366536	2005-25419
KPD #009	PM Exploration LLC	366537	2005-25420
KPD 010	PM Exploration LLC	383267	2007-17894
KPD 011	PM Exploration LLC	383268	2007-17895
KPD #012	PM Exploration LLC	366538	2005-25421
KPD #015	PM Exploration LLC	366539	2005-25422
KPD #016	PM Exploration LLC	366540	2005-25423
KPD #017	PM Exploration LLC	366541	2005-25424
KPD #018	PM Exploration LLC	366542	2005-25425
KPD #019	PM Exploration LLC	366543	2005-25426
KPD #020	PM Exploration LLC	366544	2005-25427
KPD #021	PM Exploration LLC	366545	2005-25428
KPD #022	PM Exploration LLC	366546	2005-25429
KPD #023	PM Exploration LLC	366547	2005-25430
KPD #024	PM Exploration LLC	366548	2005-25431
KPD #025	PM Exploration LLC	366549	2005-25432
KPD #026	PM Exploration LLC	366550	2005-25433
KPD #027	PM Exploration LLC	366551	2005-25434
KPD #029	PM Exploration LLC	383269	2007-17896
KPD #030	PM Exploration LLC	383270	2007-17897
KPD #034	PM Exploration LLC	366552	2005-25435
KPD #035	PM Exploration LLC	366553	2005-25436
KPD #043	PM Exploration LLC	366554	2005-25437
KPD #048	PM Exploration LLC	366555	2005-25438
KPD #057	PM Exploration LLC	366556	2005-25439
KPD #060	PM Exploration LLC	366557	2005-25440
N.D. #10	PM Exploration LLC	361755	2004-17412
N.D. #11	PM Exploration LLC	361756	2004-17413
N.D. #12	PM Exploration LLC	361955	2004-20541
N.D. #13	PM Exploration LLC	361956	2004-20440
KPD 028	PM Exploration LLC	401295	2010-14424
KPD 036	PM Exploration LLC	401296	2010-14432
KPD 037	PM Exploration LLC	401297	2010-14425
KPD 038	PM Exploration LLC	401298	2010-14417
KPD 039	PM Exploration LLC	401299	2010-14418
KPD 040	PM Exploration LLC	401300	2010-14426
KPD 041	PM Exploration LLC	401301	2010-14433
KPD 042	PM Exploration LLC	401302	2010-14439

RECEIVED
 BLM AZ STATE OFFICE
 2012 AUG 24 A 9:58
 PHOENIX, ARIZONA

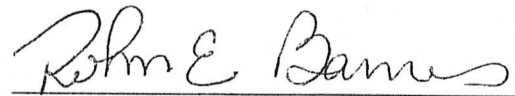
KPD 049	PM Exploration LLC	401303	2010-14440
KPD 050	PM Exploration LLC	401304	2010-14434
KPD 051	PM Exploration LLC	401305	2010-14427
KPD 052	PM Exploration LLC	401306	2010-14419
KPD 053	PM Exploration LLC	401307	2010-14420
KPD 054	PM Exploration LLC	401308	2010-14428
KPD 055	PM Exploration LLC	401309	2010-14435
KPD 056	PM Exploration LLC	401310	2010-14441
KPD 061	PM Exploration LLC	401311	2010-14442
KPD 062	PM Exploration LLC	401312	2010-14436
KPD 063	PM Exploration LLC	401313	2010-14429
KPD 064	PM Exploration LLC	401314	2010-14421
KPD 065	PM Exploration LLC	401315	2010-14437
KPD 066	PM Exploration LLC	401316	2010-14443
KPD 071	PM Exploration LLC	401317	2010-14444
KPD 072	PM Exploration LLC	401318	2010-14438
KPD 073	PM Exploration LLC	401319	2010-14430
KPD 074	PM Exploration LLC	401320	2010-14422
KPD 075	PM Exploration LLC	401321	2010-14423
KPD 076	PM Exploration LLC	401322	2010-14431
Cu 1	PM Exploration LLC	406091	2011-02393
Cu 2	PM Exploration LLC	406092	2011-02394
Cu 3	PM Exploration LLC	406093	2011-03975
Cu 4	PM Exploration LLC	406094	2011-03976
Cu 5	PM Exploration LLC	406095	2011-03977
Cu 6	PM Exploration LLC	406096	2011-03978
Cu 7	PM Exploration LLC	406097	2011-03979
Cu 8	PM Exploration LLC	406098	2011-03980
Cu 9	PM Exploration LLC	406099	2011-03981
Cu 10	PM Exploration LLC	406100	2011-03982
Cu 19	PM Exploration LLC	406109	2011-03991
Cu 20	PM Exploration LLC	406110	2011-03992
Cu 21	PM Exploration LLC	406111	2011-03993
Cu 22	PM Exploration LLC	406112	2011-03994
Cu 23	PM Exploration LLC	406113	2011-03995
Cu 24	PM Exploration LLC	406114	2011-03996
Cu 25	PM Exploration LLC	406115	2011-03997
Cu 26	PM Exploration LLC	406116	2011-03998
Cu 27	PM Exploration LLC	406117	2011-03999
Cu 41	PM Exploration LLC	406131	2011-04013
Cu 42	PM Exploration LLC	406132	2011-04014
Cu 43	PM Exploration LLC	406133	2011-04015
Cu 44	PM Exploration LLC	406134	2011-04016
Cu 45	PM Exploration LLC	406135	2011-04017
Cu 46	PM Exploration LLC	406136	2011-04018
Cu 47	PM Exploration LLC	406137	2011-04019
Cu 48	PM Exploration LLC	406138	2011-04020

PHOENIX, ARIZONA

2012 AUG 24 A 9:58

RECEIVED
BLM AZ STATE OFFICE

Cu 49	PM Exploration LLC	406139	2011-04021
Cu 50	PM Exploration LLC	406140	2011-04022
Cu 67	PM Exploration LLC	406157	2011-04039
Cu 68	PM Exploration LLC	406158	2011-04040
Cu 69	PM Exploration LLC	406159	2011-04041
Cu 70	PM Exploration LLC	406160	2011-04042
Cu 71	PM Exploration LLC	406161	2011-04043
Cu 72	PM Exploration LLC	406162	2011-04044
Cu 73	PM Exploration LLC	406163	2011-04045
Cu 74	PM Exploration LLC	406164	2011-04046
Cu 161	PM Exploration LLC	406251	2011-04123

I:\FILES\DOCS\STRA14\110776\DOC\MV1654.DOC

PHOENIX, ARIZONA

2012 AUG 24 A 9:58

RECEIVED
BLM AZ STATE OFFICE



Extremely Urgent

FedEx Ship Manager - Print Your Label(s)

Page 1 of 1

From: (520) 322-5000
Lu Ann Corliss
DeConcini Law Firm
2125 East Broadway
Suite 200
Tucson, AZ 85716

Origin ID: TUSA



J12201207160325

Ship Date: 23AUG12
ActWgt: 1.0 LB
CAD: 5333594/NET3300

Delivery Address Bar Code



Ref # 291368/110776/120165/251031/RB
Invoice #
PO #
Dept #

SHIP TO: (520) 322-5000
Arizona State Office
Bureau of Land Management
One North Central Ave., #800
Attn: Public Room
Phoenix, AZ 85004

BILL SENDER



TRK# 7988 1472 2949
0201

XH ZSYA

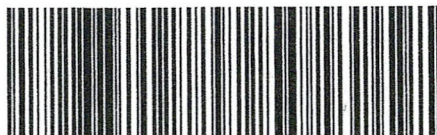

515620034AA44

FRI - 24 AUG A1
PRIORITY OVERNIGHT

85004
AZ-US
PHX

RECEIVED
BLMAZ STATE OFFICE

Comments Only

Use with the container and terms and conditions and the applicable FedEx Service. For the current FedEx Service go to fedex.com.

For Express services, go to fedex.com, for location.

Insert shipping document here.

RT 275 2 B
FZ 2949 08.24

United States Department of the Interior
Bureau of Land Management
 LANDS/RECREATION & PLANNING
 ONE N CENTRAL AVE
 PHOENIX, AZ 85004 -2203
 Phone: 602-417-9200

Receipt

No: 2640796

Transaction #: 2721427	ENTERED INTO COMPUTER
Date of Transaction: 08/27/2012	
CUSTOMER:	
DECONCINI MCDONALD YETWIN & LACY 2525 E BROADWAY BLVD STE 200 TUCSON, AZ 85716-5300 US	

LINE #	QTY	DESCRIPTION	REMARKS	UNIT PRICE	TOTAL
1	1.00	LOCATABLE MINERALS / MINING CLAIMS-NOT NEW-UNADJUD, ONE AUTH NO. ONLY / MINING CLAIM MONEY RECEIVED CASES: AMC366532/\$14000.00	MAINT FEE PYMNT (100) 2013	- n/a -	14000.00
TOTAL:					\$14,000.00

PAYMENT INFORMATION			
1	AMOUNT:	14000.00	POSTMARKED: N/A
	TYPE:	CHECK	RECEIVED: 08/27/2012
	CHECK NO:	047398	
	NAME:	DECONCINI MCDONALD YETWIN & LACY 2525 E BROADWAY BLVD STE 200 TUCSON AZ 85716-5300 US	

REMARKS

This receipt was generated by the automated BLM Collections and Billing System and is a paper representation of a portion of the official electronic record contained therein. *Lead File #'s (PB)*

- Amc 366532*
- 383267*
- 361755*
- 361955*
- 401295*
- 406091*

DECONCINI McDONALD YETWIN & LACY

A PROFESSIONAL CORPORATION
ATTORNEYS AT LAW

ROBIN E. BARNES, CP
rbarnes@dmyl.com

2525 EAST BROADWAY BOULEVARD • SUITE 200
TUCSON, ARIZONA 85716-5300
(520) 322-5000 • (520) 322-5585 (Fax)

WWW.DECONCINIMCDONALD.COM

August 1, 2011

Amc 366532
Amc 383267
Amc 361755
Amc 361955
Amc 401295
Amc 406091

Via Federal Express

Arizona State Office
Bureau of Land Management
Attention: Public Room
One North Central Avenue, Suite 800
Phoenix, AZ 85004-4427

RECEIVED
BLM AZ STATE OFFICE
2011 AUG - 3 A 7:45
PHOENIX, ARIZONA

RE: **Payment of Claim Maintenance Fee; P.M. Exploration, LLC**

Ladies and Gentlemen:

Delivered herewith is a check in the amount of \$38,360.00 as payment of the claim maintenance fees pursuant to 30 U.S.C. § 28f(a), as adjusted by 30 U.S.C. § 28j(c) and implemented by notice in 74 *Federal Register* 30959-62 (June 29, 2009), for the assessment year beginning September 1, 2011. A copy of the Certification of Payment of Maintenance Fee in Lieu of Affidavit of Annual Assessment Work to be recorded with the Cochise County Recorder's Office is also enclosed herewith.

Please return a date-stamped copy of this letter and the affidavit along with the receipt for payment to this office. Thank you for your assistance and please feel free to contact me or Marian LaLonde with any questions or concerns

Sincerely,



Robin E. Barnes, CP
Certified Paralegal

reb

- c. w/enc. Peter Rees (via email)
- Bernie Zinkhofer' (via email)
- Richard Simpson (via email)
- Pete Myers (via email)

\\FILES\DOCS\STRA14\110776\LTR\LM9397.DOC

NO. OF CLAIMS	274
AMOUNT	38360.00
RECEIPT NO.	2396009
.INIT.	SPJ

** BLM-ASO **

AUG 5 2011 am

After recording, please return to:
Marian C. LaLonde
DeConcini McDonald Yetwin & Lacy, P.C.
2525 E. Broadway Blvd., #200
Tucson, AZ 85716

PHOENIX, ARIZONA

2011 AUG - 3 A 7 46

RECEIVED
BLM AZ STATE OFFICE

STATE OF ARIZONA)
) ss:
County of Pima)

**CERTIFICATION OF PAYMENT OF MAINTENANCE FEE
IN LIEU OF AFFIDAVIT OF ANNUAL ASSESSMENT WORK**

Marian C. LaLonde, being first duly sworn, deposes and says that:

1. She is an agent for C.M. Meteor Resources, Ltd., the Lessee of the unpatented lode mining claims situated in Cochise County, Arizona (the "Claims"), the location notices of which are of record in Cochise County, and in the records of the Arizona State Office of the Bureau of Land Management under the file numbers indicated in the attached Exhibit A. The Claims are situated in Sections 25 and 36, Township 23 South, Range 19 East, Sections 1, 12 and 13, Township 24 South, Range 19 East, Sections 30, 31, 32 and 33, Township 23 South, Range 20 East, and Sections 4, 5, 6, 7, 8, 9, 16, 17 and 18, Township 24 South, Range 20 East, G&SR Mer.

2. Pursuant to the 30 U.S.C. § 28f(a), as adjusted by 30 U.S.C. § 28j(c) and implemented by notice in 74 *Federal Register* 30959-62 (June 29, 2009), the owner has paid a maintenance fee of \$140 per claim for the assessment year beginning September 1, 2011. This Certificate is in lieu of an affidavit of performance of annual assessment work or notice of intent to hold.

3. The name and address of the owner of the Claims for which this Certificate is prepared are P.M. Exploration, LLC, 2207 Crescent Dr., Dodge City, KS 67801. THIS IS NOT A CHANGE OF ADDRESS

4. The Claims are held and claimed by the owner for the valuable minerals contained therein.

DATED this 1st day of August, 2011.

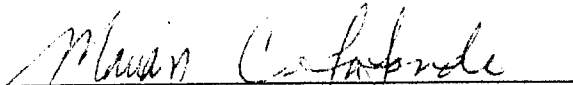
Marian C. LaLonde

Sworn and subscribed before me this 1st day of August, 2011, by Marian C. LaLonde, agent for C.M. Meteor Resources, Ltd.

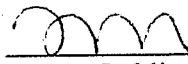
Notary Public

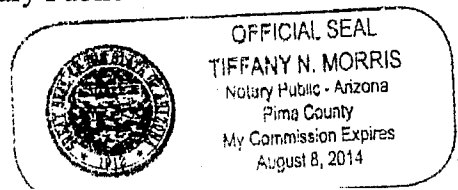

Claim Name	Owner	BLM AMC #	Cochise County Recording #	Claim Type
Original Claims				
KPD #001	PM Exploration LLC	366532	2005-25415	Lode
KPD #004	PM Exploration LLC	366533	2005-25416	Lode
KPD #005	PM Exploration LLC	366534	2005-25417	Lode
KPD #006	PM Exploration LLC	366535	2005-25418	Lode
KPD #008	PM Exploration LLC	366536	2005-25419	Lode
KPD #009	PM Exploration LLC	✓366537	2005-25420	Lode
KPD 010	PM Exploration LLC	383267	2007-17894	Lode
KPD 011	PM Exploration LLC	✓383268	2007-17895	Lode
KPD #012	PM Exploration LLC	366538	2005-25421	Lode
KPD #015	PM Exploration LLC	366539	2005-25422	Lode
KPD #016	PM Exploration LLC	366540	2005-25423	Lode
KPD #017	PM Exploration LLC	366541	2005-25424	Lode
KPD #018	PM Exploration LLC	366542	2005-25425	Lode
KPD #019	PM Exploration LLC	366543	2005-25426	Lode
KPD #020	PM Exploration LLC	366544	2005-25427	Lode
KPD #021	PM Exploration LLC	366545	2005-25428	Lode
KPD #022	PM Exploration LLC	366546	2005-25429	Lode
KPD #023	PM Exploration LLC	366547	2005-25430	Lode
KPD #024	PM Exploration LLC	366548	2005-25431	Lode
KPD #025	PM Exploration LLC	366549	2005-25432	Lode
KPD #026	PM Exploration LLC	366550	2005-25433	Lode
KPD #027	PM Exploration LLC	✓366551	2005-25434	Lode
KPD #029	PM Exploration LLC	383269	2007-17896	Lode
KPD #030	PM Exploration LLC	✓383270	2007-17897	Lode
KPD #034	PM Exploration LLC	366552	2005-25435	Lode
KPD #035	PM Exploration LLC	366553	2005-25436	Lode
KPD #043	PM Exploration LLC	366554	2005-25437	Lode
KPD #048	PM Exploration LLC	366555	2005-25438	Lode
KPD #057	PM Exploration LLC	366556	2005-25439	Lode
KPD #060	PM Exploration LLC	✓366557	2005-25440	Lode
N.D. #10	PM Exploration LLC	361755	2004-17412	Lode
N.D. #11	PM Exploration LLC	✓361756	2004-17413	Lode
N.D. #12	PM Exploration LLC	361955	2004-20541	Lode
N.D. #13	PM Exploration LLC	✓361956	2004-20440	Lode

Claims added in 2010

KPD #028	PM Exploration LLC	401295	2010-14424	Lode
KPD #036	PM Exploration LLC	401296	2010-14432	Lode
KPD #037	PM Exploration LLC	401297	2010-14425	Lode
KPD #038	PM Exploration LLC	401298	2010-14417	Lode
KPD #039	PM Exploration LLC	401299	2010-14418	Lode
KPD #040	PM Exploration LLC	401300	2010-14426	Lode
KPD #041	PM Exploration LLC	401301	2010-14433	Lode

PHOENIX, ARIZONA

2011 AUG - 3 A 7:46

RECEIVED
BLM AZ STATE OFFICE

KPD #042	PM Exploration LLC	401302	2010-14439	Lode
KPD #049	PM Exploration LLC	401303	2010-14440	Lode
KPD #050	PM Exploration LLC	401304	2010-14434	Lode
KPD #051	PM Exploration LLC	401305	2010-14427	Lode
KPD #052	PM Exploration LLC	401306	2010-14419	Lode
KPD #053	PM Exploration LLC	401307	2010-14420	Lode
KPD #054	PM Exploration LLC	401308	2010-14428	Lode
KPD #055	PM Exploration LLC	401309	2010-14435	Lode
KPD #056	PM Exploration LLC	401310	2010-14441	Lode
KPD #061	PM Exploration LLC	401311	2010-14442	Lode
KPD #062	PM Exploration LLC	401312	2010-14436	Lode
KPD #063	PM Exploration LLC	401313	2010-14429	Lode
KPD #064	PM Exploration LLC	401314	2010-14421	Lode
KPD #065	PM Exploration LLC	401315	2010-14437	Lode
KPD #066	PM Exploration LLC	401316	2010-14443	Lode
KPD #071	PM Exploration LLC	401317	2010-14444	Lode
KPD #072	PM Exploration LLC	401318	2010-14438	Lode
KPD #073	PM Exploration LLC	401319	2010-14430	Lode
KPD #074	PM Exploration LLC	401320	2010-14422	Lode
KPD #075	PM Exploration LLC	401321	2010-14423	Lode
KPD #076	PM Exploration LLC	✓401322	2010-14431	Lode

CU Claims – acquired 2011

Cu 1	PM Exploration LLC	406091	2011-02393	Lode
Cu 2	PM Exploration LLC	406092	2011-02394	Lode
Cu 3	PM Exploration LLC	406093	2011-03975	Lode
Cu 4	PM Exploration LLC	406094	2011-03976	Lode
Cu 5	PM Exploration LLC	406095	2011-03977	Lode
Cu 6	PM Exploration LLC	406096	2011-03978	Lode
Cu 7	PM Exploration LLC	406097	2011-03979	Lode
Cu 8	PM Exploration LLC	406098	2011-03980	Lode
Cu 9	PM Exploration LLC	406099	2011-03981	Lode
Cu 10	PM Exploration LLC	406100	2011-03982	Lode
Cu 11	PM Exploration LLC	406101	2011-03983	Lode
Cu 12	PM Exploration LLC	406102	2011-03984	Lode
Cu 13	PM Exploration LLC	406103	2011-03985	Lode
Cu 14	PM Exploration LLC	406104	2011-03986	Lode
Cu 15	PM Exploration LLC	406105	2011-03987	Lode
Cu 16	PM Exploration LLC	406106	2011-03988	Lode
Cu 17	PM Exploration LLC	406107	2011-03989	Lode
Cu 18	PM Exploration LLC	406108	2011-03990	Lode
Cu 19	PM Exploration LLC	406109	2011-03991	Lode
Cu 20	PM Exploration LLC	406110	2011-03992	Lode
Cu 21	PM Exploration LLC	406111	2011-03993	Lode
Cu 22	PM Exploration LLC	406112	2011-03994	Lode
Cu 23	PM Exploration LLC	✓406113	2011-03995	Lode

PIQUELIX, ARIZONA

2011 AUG - 3 A 7 46

RECEIVED
BLM AZ STATE OFFICE

Cu 24	PM Exploration LLC	406114	2011-03996	Lode
Cu 25	PM Exploration LLC	406115	2011-03997	Lode
Cu 26	PM Exploration LLC	406116	2011-03998	Lode
Cu 27	PM Exploration LLC	406117	2011-03999	Lode
Cu 28	PM Exploration LLC	406118	2011-04000	Lode
Cu 29	PM Exploration LLC	406119	2011-04001	Lode
Cu 30	PM Exploration LLC	406120	2011-04002	Lode
Cu 31	PM Exploration LLC	406121	2011-04003	Lode
Cu 32	PM Exploration LLC	406122	2011-04004	Lode
Cu 33	PM Exploration LLC	406123	2011-04005	Lode
Cu 34	PM Exploration LLC	406124	2011-04006	Lode
Cu 35	PM Exploration LLC	406125	2011-04007	Lode
Cu 36	PM Exploration LLC	406126	2011-04008	Lode
Cu 37	PM Exploration LLC	406127	2011-04009	Lode
Cu 38	PM Exploration LLC	406128	2011-04010	Lode
Cu 39	PM Exploration LLC	406129	2011-04011	Lode
Cu 40	PM Exploration LLC	406130	2011-04012	Lode
Cu 41	PM Exploration LLC	406131	2011-04013	Lode
Cu 42	PM Exploration LLC	406132	2011-04014	Lode
Cu 43	PM Exploration LLC	406133	2011-04015	Lode
Cu 44	PM Exploration LLC	406134	2011-04016	Lode
Cu 45	PM Exploration LLC	406135	2011-04017	Lode
Cu 46	PM Exploration LLC	406136	2011-04018	Lode
Cu 47	PM Exploration LLC	406137	2011-04019	Lode
Cu 48	PM Exploration LLC	406138	2011-04020	Lode
Cu 49	PM Exploration LLC	406139	2011-04021	Lode
Cu 50	PM Exploration LLC	406140	2011-04022	Lode
Cu 51	PM Exploration LLC	406141	2011-04023	Lode
Cu 52	PM Exploration LLC	406142	2011-04024	Lode
Cu 53	PM Exploration LLC	406143	2011-04025	Lode
Cu 54	PM Exploration LLC	406144	2011-04026	Lode
Cu 55	PM Exploration LLC	406145	2011-04027	Lode
Cu 56	PM Exploration LLC	406146	2011-04028	Lode
Cu 57	PM Exploration LLC	406147	2011-04029	Lode
Cu 58	PM Exploration LLC	406148	2011-04030	Lode
Cu 59	PM Exploration LLC	406149	2011-04031	Lode
Cu 60	PM Exploration LLC	406150	2011-04032	Lode
Cu 61	PM Exploration LLC	406151	2011-04033	Lode
Cu 62	PM Exploration LLC	406152	2011-04034	Lode
Cu 63	PM Exploration LLC	406153	2011-04035	Lode
Cu 64	PM Exploration LLC	406154	2011-04036	Lode
Cu 65	PM Exploration LLC	406155	2011-04037	Lode
Cu 66	PM Exploration LLC	406156	2011-04038	Lode
Cu 67	PM Exploration LLC	406157	2011-04039	Lode
Cu 68	PM Exploration LLC	406158	2011-04040	Lode
Cu 69	PM Exploration LLC	406159	2011-04041	Lode
Cu 70	PM Exploration LLC	406160	2011-04042	Lode
Cu 71	PM Exploration LLC	✓406161	2011-04043	Lode

PHOENIX, ARIZONA

2011 AUG -3 A 7:46

RECEIVED
BLM AZ STATE OFFICE

Cu 72	PM Exploration LLC	406162	2011-04044	Lode
Cu 73	PM Exploration LLC	406163	2011-04045	Lode
Cu 74	PM Exploration LLC	406164	2011-04046	Lode
Cu 75	PM Exploration LLC	406165	2011-04047	Lode
Cu 76	PM Exploration LLC	406166	2011-04048	Lode
Cu 77	PM Exploration LLC	406167	2011-04049	Lode
Cu 78	PM Exploration LLC	406168	2011-04050	Lode
Cu 79	PM Exploration LLC	406169	2011-04051	Lode
Cu 80	PM Exploration LLC	406170	2011-04052	Lode
Cu 81	PM Exploration LLC	406171	2011-04053	Lode
Cu 82	PM Exploration LLC	406172	2011-04054	Lode
Cu 83	PM Exploration LLC	406173	2011-04055	Lode
Cu 84	PM Exploration LLC	406174	2011-04056	Lode
Cu 85	PM Exploration LLC	406175	2011-04057	Lode
Cu 86	PM Exploration LLC	406176	2011-04058	Lode
Cu 87	PM Exploration LLC	406177	2011-04059	Lode
Cu 88	PM Exploration LLC	406178	2011-04060	Lode
Cu 89	PM Exploration LLC	406179	2011-04061	Lode
Cu 90	PM Exploration LLC	406180	2011-04062	Lode
Cu 91	PM Exploration LLC	406181	2011-04063	Lode
Cu 92	PM Exploration LLC	406182	2011-04064	Lode
Cu 93	PM Exploration LLC	406183	2011-04065	Lode
Cu 94	PM Exploration LLC	406184	2011-04066	Lode
Cu 95	PM Exploration LLC	406185	2011-04067	Lode
Cu 96	PM Exploration LLC	406186	2011-04068	Lode
Cu 97	PM Exploration LLC	406187	2011-04069	Lode
Cu 98	PM Exploration LLC	406188	2011-04070	Lode
Cu 99	PM Exploration LLC	406189	2011-04071	Lode
Cu 100	PM Exploration LLC	406190	2011-04072	Lode
Cu 101	PM Exploration LLC	406191	2011-04101	Lode
Cu 102	PM Exploration LLC	406192	2011-04102	Lode
Cu 103	PM Exploration LLC	406193	2011-04103	Lode
Cu 104	PM Exploration LLC	406194	2011-04104	Lode
Cu 105	PM Exploration LLC	406195	2011-04105	Lode
Cu 106	PM Exploration LLC	406196	2011-04106	Lode
Cu 107	PM Exploration LLC	406197	2011-04107	Lode
Cu 108	PM Exploration LLC	406198	2011-04108	Lode
Cu 109	PM Exploration LLC	406199	2011-04109	Lode
Cu 110	PM Exploration LLC	406200	2011-04110	Lode
Cu 111	PM Exploration LLC	406201	2011-04073	Lode
Cu 112	PM Exploration LLC	406202	2011-04074	Lode
Cu 113	PM Exploration LLC	406203	2011-04075	Lode
Cu 114	PM Exploration LLC	406204	2011-04076	Lode
Cu 115	PM Exploration LLC	406205	2011-04077	Lode
Cu 116	PM Exploration LLC	406206	2011-04078	Lode
Cu 117	PM Exploration LLC	406207	2011-04079	Lode
Cu 118	PM Exploration LLC	406208	2011-04080	Lode
Cu 119	PM Exploration LLC	✓406209	2011-04081	Lode

PHOENIX, ARIZONA

2011 AUG - 3 A T 46

RECEIVED
BLM AZ STATE OFFICE

Cu 120 PM Exploration LLC	406210	2011-04082	Lode
Cu 121 PM Exploration LLC	406211	2011-04083	Lode
Cu 122 PM Exploration LLC	406212	2011-04084	Lode
Cu 123 PM Exploration LLC	406213	2011-04085	Lode
Cu 124 PM Exploration LLC	406214	2011-04086	Lode
Cu 125 PM Exploration LLC	406215	2011-04087	Lode
Cu 126 PM Exploration LLC	406216	2011-04088	Lode
Cu 127 PM Exploration LLC	406217	2011-04089	Lode
Cu 128 PM Exploration LLC	406218	2011-04090	Lode
Cu 129 PM Exploration LLC	406219	2011-04091	Lode
Cu 130 PM Exploration LLC	406220	2011-04092	Lode
Cu 131 PM Exploration LLC	406221	2011-04093	Lode
Cu 132 PM Exploration LLC	406222	2011-04094	Lode
Cu 133 PM Exploration LLC	406223	2011-04095	Lode
Cu 134 PM Exploration LLC	406224	2011-04096	Lode
Cu 135 PM Exploration LLC	406225	2011-04097	Lode
Cu 136 PM Exploration LLC	406226	2011-04098	Lode
Cu 137 PM Exploration LLC	406227	2011-04099	Lode
Cu 138 PM Exploration LLC	406228	2011-04100	Lode
Cu 139 PM Exploration LLC	406229	2011-04111	Lode
Cu 140 PM Exploration LLC	406230	2011-04112	Lode
Cu 141 PM Exploration LLC	406231	2011-04113	Lode
Cu 142 PM Exploration LLC	406232	2011-04114	Lode
Cu 143 PM Exploration LLC	406233	2011-04115	Lode
Cu 144 PM Exploration LLC	406234	2011-04116	Lode
Cu 145 PM Exploration LLC	406235	2011-04117	Lode
Cu 146 PM Exploration LLC	406236	2011-04118	Lode
Cu 147 PM Exploration LLC	406237	2011-04119	Lode
Cu 148 PM Exploration LLC	406238	2011-04120	Lode
Cu 149 PM Exploration LLC	406239	2011-04121	Lode
Cu 150 PM Exploration LLC	406240	2011-04122	Lode
Cu 151 PM Exploration LLC	406241	2011-04123	Lode
Cu 152 PM Exploration LLC	406242	2011-04124	Lode
Cu 153 PM Exploration LLC	406243	2011-04125	Lode
Cu 154 PM Exploration LLC	406244	2011-04126	Lode
Cu 155 PM Exploration LLC	406245	2011-04127	Lode
Cu 156 PM Exploration LLC	406246	2011-04128	Lode
Cu 157 PM Exploration LLC	406247	2011-04129	Lode
Cu 158 PM Exploration LLC	406248	2011-04130	Lode
Cu 159 PM Exploration LLC	406249	2011-04131	Lode
Cu 160 PM Exploration LLC	406250	2011-04132	Lode
Cu 161 PM Exploration LLC	406251	2011-04133	Lode
Cu 162 PM Exploration LLC	406252	2011-04134	Lode
Cu 163 PM Exploration LLC	406253	2011-04135	Lode
Cu 164 PM Exploration LLC	406254	2011-04136	Lode
Cu 165 PM Exploration LLC	406255	2011-04137	Lode
Cu 166 PM Exploration LLC	406256	2011-04138	Lode
Cu 167 PM Exploration LLC	√406257	2011-04139	Lode

PHOENIX, ARIZONA

2011 AUG -3 A 7:46

RECEIVED
BLM AZ STATE OFFICE

Cu 168 PM Exploration LLC	406258	2011-04140	Lode
Cu 169 PM Exploration LLC	406259	2011-04141	Lode
Cu 170 PM Exploration LLC	406260	2011-04142	Lode
Cu 171 PM Exploration LLC	406261	2011-04143	Lode
Cu 172 PM Exploration LLC	406262	2011-04144	Lode
Cu 173 PM Exploration LLC	406263	2011-04145	Lode
Cu 174 PM Exploration LLC	406264	2011-04146	Lode
Cu 175 PM Exploration LLC	406265	2011-04147	Lode
Cu 176 PM Exploration LLC	406266	2011-04148	Lode
Cu 177 PM Exploration LLC	406267	2011-04149	Lode
Cu 178 PM Exploration LLC	406268	2011-04150	Lode
Cu 179 PM Exploration LLC	406269	2011-04151	Lode
Cu 180 PM Exploration LLC	406270	2011-04152	Lode
Cu 181 PM Exploration LLC	406271	2011-04153	Lode
Cu 182 PM Exploration LLC	406272	2011-04154	Lode
Cu 183 PM Exploration LLC	406273	2011-04155	Lode
Cu 184 PM Exploration LLC	406274	2011-04156	Lode
Cu 185 PM Exploration LLC	406275	2011-04157	Lode
Cu 186 PM Exploration LLC	406276	2011-04158	Lode
Cu 187 PM Exploration LLC	406277	2011-04159	Lode
Cu 188 PM Exploration LLC	406278	2011-04160	Lode
Cu 189 PM Exploration LLC	406279	2011-04161	Lode
Cu 190 PM Exploration LLC	406280	2011-04162	Lode
Cu 191 PM Exploration LLC	406281	2011-04163	Lode
Cu 192 PM Exploration LLC	406282	2011-04164	Lode
Cu 193 PM Exploration LLC	406283	2011-04165	Lode
Cu 194 PM Exploration LLC	406284	2011-04166	Lode
Cu 195 PM Exploration LLC	406285	2011-04167	Lode
Cu 196 PM Exploration LLC	406286	2011-04168	Lode
Cu 197 PM Exploration LLC	406287	2011-04169	Lode
Cu 198 PM Exploration LLC	406288	2011-04170	Lode
Cu 199 PM Exploration LLC	406289	2011-04171	Lode
Cu 200 PM Exploration LLC	406290	2011-04172	Lode
Cu 201 PM Exploration LLC	406291	2011-04173	Lode
Cu 202 PM Exploration LLC	406292	2011-04174	Lode
Cu 203 PM Exploration LLC	406293	2011-04175	Lode
Cu 204 PM Exploration LLC	406294	2011-04176	Lode
Cu 205 PM Exploration LLC	406295	2011-04177	Lode
Cu 206 PM Exploration LLC	406296	2011-04178	Lode
Cu 207 PM Exploration LLC	406297	2011-04179	Lode
Cu 208 PM Exploration LLC	406298	2011-04180	Lode
Cu 209 PM Exploration LLC	406299	2011-04181	Lode
Cu 210 PM Exploration LLC	406300	2011-04182	Lode
Cu 211 PM Exploration LLC	406301	2011-04183	Lode
Cu 212 PM Exploration LLC	✓ 406302	2011-04184	Lode

PHOENIX, ARIZONA

2011 AUG - 3 A 7 46

RECEIVED
BLM AZ STATE OFFICE

United States Department of the Interior
Bureau of Land Management
 LANDS/RECREATION & PLANNING
 ONE N CENTRAL AVE
 PHOENIX, AZ 85004 -2203
 Phone: 602-417-9200

Receipt

No: 2396009

Transaction #: 2471127	
Date of Transaction: 08/03/2011	
CUSTOMER:	
DECONCINI MCDONALD YETWIN & LACY 2525 E BROADWAY BLVD STE 200 TUCSON, AZ 85716-5300 US	

LINE #	QTY	DESCRIPTION	REMARKS	UNIT PRICE	TOTAL
1	1.00	LOCATABLE MINERALS / MINING CLAIMS-NOT NEW-UNADJUD, ONE AUTH NO. ONLY / MINING CLAIM MONEY RECEIVED CASES: AMC366532/\$38360.00	MAINT-274	- n/a -	38360.00
TOTAL:					\$38,360.00

PAYMENT INFORMATION						
1	AMOUNT:	38360.00	POSTMARKED:	N/A		
	TYPE:	CHECK	RECEIVED:	08/03/2011		
	CHECK NO:	604032228				
	NAME:	STRATON RESOURCES INC 700-1199 W HASTING ST VANCOUVER, CANADA BRITISH COLUMBIA NS V6E 3T5				

REMARKS

This receipt was generated by the automated BLM Collections and Billing System and is a paper representation of a portion of the official electronic record contained therein.

AMC 361955
 AMC 361755
 AMC 366532
 AMC 383267

Notice Of Intention To Hold Mining Claim(s)

This Notice of Intention to Hold Mining Claim(s) is made pursuant to 43 C.F.R., subpart 3833.2.3, by:

Name (owner or agent) P.M. EXPLORATION LLC

Address 2207 CRESCENT DRIVE

City, State, Zip DODGE CITY, KS. 67801

Claim Name	BLM AMC#	Cochise County Recording #
<u>KPD#001</u>	<u>AMC366532</u>	<u>050725415</u>
<u>KPD#004</u>	<u>AMC366533</u>	<u>050725416</u>
<u>KPD#005</u>	<u>AMC366534</u>	<u>050725417</u>
<u>KPD#006</u>	<u>AMC366535</u>	<u>050725418</u>
<u>KPD#008</u>	<u>AMC366536</u>	<u>050725419</u>
<u>KPD#009</u>	<u>AMC366537</u>	<u>050725419</u>
<u>KPD#010</u>	<u>AMC383267</u>	<u>070517894</u>
<u>KPD#011</u>	<u>AMC383268</u>	<u>070517895</u>

RECEIVED
 BLM AZ STATE OFFICE
 2010 AUG 16 P 12:34
 PHOENIX, ARIZONA

ADDITIONAL CLAIMS ARE LISTED ON ATTACHED SHEET

The above named claim(s) is (are) held claimed by the owner(s) for the valuable mineral contained therein. I (we) intend to continue development of the claim(s).

Annual assessment work or report of geological, geochemical or geophysical survey is not required because the owner has paid a rental fee of \$140.00 per claim for the assessment year ending August 31, 2010 and is paying \$140.00 per claim for an advanced rental fee for the assessment work for the year beginning on September 1, 2010. Owner further states that mineral production activities have occurred upon the claims during the last assessment year that would normally qualify as annual assessment work.

Signed [Signature]

Date 7-10-10

NO. OF CLAIMS 34
 AMOUNT \$4760.00
 RECEIPT NO. 2191733
 INIT. [Signature]

**** BLM-ASO ****

ADDITIONAL CLAIMS FOR P.M. EXPLORATION LLC

Notice of Intention To Hold Mining Claims

Claim Name	BLM AMC#	Cochise Co. Recording #
KPD#012	AMC366538	050725420
KPD#015	AMC366539	050725421
KPD#016	AMC366540	050725422
KPD#017	AMC366541	050725423
KPD#018	AMC366542	050725424
KPD#019	AMC366543	050725425
KPD#020	AMC366544	050725426
KPD#021	AMC366545	050725427
KPD#022	AMC366546	050725428
KPD#023	AMC366547	050725429
KPD#024	AMC366548	050725430
KPD#025	AMC366549	050725431
KPD#026	AMC366550	050725432
KPD#027	AMC366551	050725433
KPD#029	AMC383269	070517896
KPD#030	AMC383270	070517897
KPD#034	AMC366552	050725434
KPD#035	AMC366553	050725435
KPD#043	AMC366554	050725436
KPD#048	AMC366555	050725437
KPD#057	AMC366556	050725438
KPD#060	AMC366557	050725439
N.D.#10	AMC361755	040617412
N.D.#11	AMC361756	040617413
N.D.#12	AMC361955	040620541
N.D.#13	AMC361956	040620540

RECEIVED
BLM AZ STATE OFFICE
2010 AUG 16 P. 12: 34
PHOENIX, ARIZONA

Signed

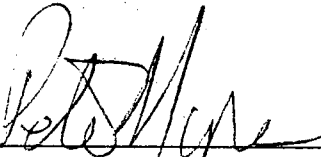

Date

7-10-10

ENTERED INTO COMPUTER

AUG 23 2010

United States Department of the Interior
Bureau of Land Management
 LANDS/RECREATION & PLANNING
 ONE N CENTRAL AVE
 PHOENIX, AZ 85004 -2203
 Phone:

Receipt

No: 2191733

Transaction #: 2261490		ENTERED INTO COMPUTER
Date of Transaction: 08/16/2010		
CUSTOMER:	P.M. EXPLORATION LLC 2207 CRESCENT DR DODGE CITY,KS 67801-2827 US	AUG 23 2010

LINE #	QTY	DESCRIPTION	REMARKS	UNIT PRICE	TOTAL
1	1.00	LOCATABLE MINERALS / MINING CLAIMS-NOT NEW-UNADJUD,ONE AUTH NO. ONLY / MINING CLAIM MONEY RECEIVED CASES: AMC366532/\$4760.00	MAINT FEE PYMNT (34) 2011	- n/a -	4760.00
TOTAL:					\$4,760.00

PAYMENT INFORMATION			
1	AMOUNT:	4760.00	POSTMARKED: N/A
	TYPE:	FOREIGN CHECK	RECEIVED: 08/16/2010
	CHECK NO:	645146	
	NAME:	AZ COPPER CORP 675 HASTINGS ST W VANCOUVER BC V6B1N2 CA	

REMARKS

This receipt was generated by the automated BLM Collections and Billing System and is a paper representation of a portion of the official electronic record contained therein.

AMC 388635
366532
383264
361755
361955

Notice Of Intention To Hold Mining Claim(s)

This Notice of Intention to Hold Mining Claim(s) is made pursuant to 43 C.F.R., subpart 3833.2.3, by:

Name (owner or agent) D. D. Exploration LLC

Address 2207 CRESCENT DRIVE

City, State, Zip DODGE CITY, KS. 67801

Claim Name	BLM AMC#	Cochise County Recording #
Toni Ann #001	AMC 388635	071136135
Toni Ann #002	AMC 388636	071136134

The above named claim(s) is (are) held claimed by the owner(s) for the valuable mineral contained therein. I (we) intend to continue development of the claim(s).

Annual assessment work or report of geological, geochemical or geophysical survey is not required because the owner is paying \$125.00 per claim for an advanced rental fee for the assessment work for the year beginning on September 1, 2008. Owner further states that mineral production activities have occurred upon the claims during the last assessment year that would normally qualify as annual assessment work.

Signed Peter Magur

Date 8-21-08

ENTERED INTO COMPUTER
9/14/08 QB

Notice Of Intention To Hold Mining Claim(s)

This Notice of Intention to Hold Mining Claim(s) is made pursuant to 43 C.F.R., subpart 3833.2.3, by:

Name (owner or agent) P.M. EXPLORATION LLC

Address 2207 CRESCENT DRIVE

City, State, Zip DODGE CITY, KS. 67801

Claim Name	BLM AMC#	Cochise County Recording #
L <u>KPD#001</u>	<u>AMC366532</u>	<u>050725415</u>
<u>KPD#004</u>	<u>AMC366533</u>	<u>050725416</u>
<u>KPD#005</u>	<u>AMC366534</u>	<u>050725417</u>
<u>KPD#006</u>	<u>AMC366535</u>	<u>050725418</u>
<u>KPD#008</u>	<u>AMC366536</u>	<u>050725419</u>
<u>KPD#009</u>	<u>AMC366537</u>	<u>050725419</u>
L <u>KPD#010</u>	<u>AMC383267</u>	<u>070517894</u>
<u>KPD#011</u>	<u>AMC383268</u>	<u>070517895</u>

ADDITIONAL CLAIMS ARE LISTED ON ATTACHED SHEET

The above named claim(s) is (are) held claimed by the owner(s) for the valuable mineral contained therein. I (we) intend to continue development of the claim(s).

Annual assessment work or report of geological, geochemical or geophysical survey is not required because the owner has paid a rental fee of \$125.00 per claim for the assessment year ending September 1, 2008 and is paying \$125.00 per claim for an advanced rental fee for the assessment work for the year beginning on September 1, 2009. Owner further states that mineral production activities have occurred upon the claims during the last assessment year that would normally qualify as annual assessment work.

Signed Peter M. [Signature]

Date 8-21-08

ADDITIONAL CLAIMS FOR P.M. EXPLORATION LLC

Notice of Intention To Hold Mining Claims

Claim Name	BLM AMC#	Cochise Co. Recording #
KPD#012	AMC366538	050725420
KPD#015	AMC366539	050725421
KPD#016	AMC366540	050725422
KPD#017	AMC366541	050725423
KPD#018	AMC366542	050725424
KPD#019	AMC366543	050725425
KPD#020	AMC366544	050725426
KPD#021	AMC366545	050725427
KPD#022	AMC366546	050725428
KPD#023	AMC366547	050725429
KPD#024	AMC366548	050725430
KPD#025	AMC366549	050725431
KPD#026	AMC366550	050725432
KPD#027	AMC366551	050725433
KPD#029	AMC383269	070517896
KPD#030	AMC383270	070517897
KPD#034	AMC366552	050725434
KPD#035	AMC366553	050725435
KPD#043	AMC366554	050725436
KPD#048	AMC366555	050725437
KPD#057	AMC366556	050725438
KPD#060	AMC366557	050725439
N.D.#10	AMC361755	040617412
N.D.#11	AMC361756	040617413
N.D.#12	AMC361955	040620541
N.D.#13	AMC361956	040620540

Signed

Peter Myers

Date

8-21-08

United States Department of the Interior
 Bureau of Land Management
 BUSINESS & SUPPORT SVCS DIV
 ONE N CENTRAL AVE SUITE 800
 PHOENIX, AZ 85004 -4427
 Phone: (602) 417-9200

Receipt

No: 1771434

Transaction #: 1829140	
Date of Transaction: 08/26/2008	
CUSTOMER:	D.D. EXPLORATION, L.L.C 2207 CRESCENT DR DODGE CITY,KS 67801

LINE #	QTY	DESCRIPTION	REMARKS	UNIT PRICE	TOTAL
1	1.00	LOCATABLE MINERALS / MINING CLAIMS-NOT NEW-UNADJUD,ONE AUTH NO. ONLY / MINING CLAIM MONEY RECEIVED (455) CASES: AMC366538/\$4500.00	MAINT 2009	- n/a -	4500.00
TOTAL:					\$4,500.00

PAYMENT INFORMATION					
1	AMOUNT:	\$4,250.00	POSTMARKED:	8/21/08 0:00	
	TYPE:	CHECK	RECEIVED:	08/26/2008	
	CHECK NO:	1482			
	NAME:	MYERS, PETER D 2207 CRESCENT DR DODGE CITY KS 67801			
2	AMOUNT:	\$250.00	POSTMARKED:	8/21/08 0:00	
	TYPE:	CHECK	RECEIVED:	08/26/2008	
	CHECK NO:	1483			
	NAME:	MYERS, PETER D 2207 CRESCENT DR DODGE CITY KS 67801			

REMARKS

This receipt was generated by the automated BLM Collections and Billing System and is a paper representation of a portion of the official electronic record contained therein.

AMC366532
383267
361755
361955

Notice Of Intention To Hold Mining Claim(s)

This Notice of Intention to Hold Mining Claim(s) is made pursuant to 43 C.F.R., subpart 3833.2.3, by:

Name (owner or agent) P.M. EXPLORATION LLC

Address 2207 CRESCENT DRIVE

City, State, Zip DODGE CITY, KS. 67801

Claim Name	BLM AMC#	Cochise County Recording #
<u>KPD#001</u>	<u>AMC366532</u>	<u>050725415</u>
<u>KPD#004</u>	<u>AMC366533</u>	<u>050725416</u>
<u>KPD#005</u>	<u>AMC366534</u>	<u>050725417</u>
<u>KPD#006</u>	<u>AMC366535</u>	<u>050725418</u>
<u>KPD#008</u>	<u>AMC366536</u>	<u>050725419</u>
<u>KPD#009</u>	<u>AMC366537</u>	<u>050725419</u>
<u>KPD#010</u>	<u>AMC383267</u>	<u>070517894</u>
<u>KPD#011</u>	<u>AMC383268</u>	<u>070517895</u>

PHOENIX, ARIZONA

2007 AUG 30 P 4: 27

RECEIVED
B.L.M. AZ STATE OFFICE

8004

ADDITIONAL CLAIMS ARE LISTED ON ATTACHED SHEET

The above named claim(s) is (are) held claimed by the owner(s) for the valuable mineral contained therein. I (we) intend to continue development of the claim(s).

Annual assessment work or report of geological, geochemical or geophysical survey is not required because the owner has paid a rental fee of \$125.00 per claim for the assessment year ending September 1, 2006 and is paying \$125.00 per claim for an advanced rental fee for the assessment work for the year beginning on September 1, 2007. Owner further states that mineral production activities have occurred upon the claims during the last assessment year that would normally qualify as annual assessment work.

Signed Peter Myers

Date 8-24-07

ENTERED INTO COMPUTER
9/10/2007 PB + VERIFIED

ADDITIONAL CLAIMS FOR P.M. EXPLORATION LLC

Notice of Intention To Hold Mining Claims

Claim Name	BLM AMC#	Cochise Co. Recording #
KPD#012	AMC366538	050725420
KPD#015	AMC366539	050725421
KPD#016	AMC366540	050725422
KPD#017	AMC366541	050725423
KPD#018	AMC366542	050725424
KPD#019	AMC366543	050725425
KPD#020	AMC366544	050725426
KPD#021	AMC366545	050725427
KPD#022	AMC366546	050725428
KPD#023	AMC366547	050725429
KPD#024	AMC366548	050725430
KPD#025	AMC366549	050725431
KPD#026	AMC366550	050725432
KPD#027	AMC366551	050725433
KPD#029	AMC383269	070517896
KPD#030	AMC383270	070517897
KPD#034	AMC366552	050725434
KPD#035	AMC366553	050725435
KPD#043	AMC366554	050725436
KPD#048	AMC366555	050725437
KPD#057	AMC366556	050725438
KPD#060	AMC366557	050725439

22
885

Signed

Peter Myers

Date

8-24-07

PHOENIX, ARIZONA

2007 AUG 30 P 4: 27

RECEIVED
B.L.M. AZ STATE OFFICE

NOTICE OF INTENTION TO HOLD MINING CLAIMS(S)

This Notice of Intention to Hold Mining Claim(s) is made pursuant to 43 C.F.R., subpart 3833.2.3, by:

Name (owner or agent) D.D. EXPLORATION LLC

Address 2207 CRESCENT DR.

City, State, Zip DODGE CITY, KS 67801

<u>Claim Name</u>	<u>BLM AMC#</u>	<u>COCHISE COUNTY RECORDING#</u>
<u>N.D.#10</u>	<u>AMC361755</u>	<u>040617412</u>
<u>N.D.#11</u>	<u>AMC361756</u>	<u>040617413</u>
<u>N.D.#12</u>	<u>AMC361955</u>	<u>040620541</u>
<u>N.D.#13</u>	<u>AMC361956</u>	<u>040620540</u>

RECEIVED
 BLM ALABAMA STATE OFFICE
 2007 AUG 30 P 4: 27
 PHOENIX, ARIZONA

(4)
SAC

The above named claim(s) is (are) held and claimed by the owner(s) for the valuable mineral contained therein. I (we) intend to continue development of the claim(s).

Annual assessment work or report of geological, geochemical or geophysical survey is not required because OWNER IS PAYING AN ADVANCED RENTAL FEE OF \$125.00 PER CLAIM FOR THE ASSESSMENT YEAR BEGINNING SEPTEMBER 1, 2007. OWNER STATES FOR MINERAL PRODUCTION ACTIVITIES HAVE OCCURRED ON THE CLAIMS THAT WOULD NORMALLY QUALIFIED FOR ANNUAL ASSESSMENT WORK FOR THE YEAR ENDING SEPTEMBER 1, 2007

Signed By Peter Meyer
 Date 8-24-07

United States Department of the Interior
Bureau of Land Management
 BUSINESS & SUPPORT SVCS DIV
 ONE N CENTRAL AVE SUITE 800
 PHOENIX, AZ 85004 -4427
 Phone: (602) 417-9200

Receipt

No: 1558280

Transaction #: 1609924		ENTERED INTO COMPUTER
Date of Transaction: 08/30/2007		
CUSTOMER:	PETER MYERS 2207 CRESCENT DR DODGE CITY,KS 67801	SEP 10 2007 PB + VERIFIED

LINE #	QTY	DESCRIPTION	REMARKS	UNIT PRICE	TOTAL
1	1.00	LOCATABLE MINERALS / MINING CLAIMS- NOT NEW-UNADJUD, ONE AUTH NO. ONLY / MINING CLAIM MONEY RECEIVED (455) CASES: AMC366532/\$4250.00	MAINT 2008 (34)	- n/a -	4250.00
TOTAL:					\$4,250.00

PAYMENT INFORMATION			
NOTE: Items will appear on credit card statement as "Bureau of Land Management".			
1	AMOUNT:	\$4,250.00	POSTMARKED: N/A
	TYPE:	CREDIT CARD	RECEIVED: 08/30/2007
	NAME:	MYERS, PETER 2207 CRESCENT DR DODGE CITY KS 67801	
	CARD NO:	XXXXXXXXXXXX9231	AUTH CODE: 03551B
	NAME ON CARD:	PETER D MYERS	
	EXPIRES:	06/30/2009	
	SIGNATURE:		

REMARKS

This receipt was generated by the automated BLM Collections and Billing System and is a paper representation of a portion of the official electronic record contained therein.

361755-361756
 366532-366559 361955-361956
 383267-383270

Dear B. L. M., 8-24-07
Please record these
"Notice of Intention to Hold
Mining Claims." There is
a total of 34 claims,
at \$125 each, which
makes the total fees \$4,250.⁰⁰
I would like to pay the
fees with my MasterCard.

the # is [REDACTED]
[REDACTED], the expiration date is 06/09.
The name on the card is
Peter D. Myers.

Please call me if you
have any questions or
problems.
Thanks for your time.

Yours Truly,
Pete Myers
620 430 3188
620 225 1991

Message:

34 ROWS RETRIEVED

CBS Export Results Report

Include Resolved Records

Record Status

Search Criteria Responsible Ar

Error Records (E/M/I)

Enter export Date (mm/dd/yyyy) ALL

User (U,X)

Accepted Records (A/W)

Serial Number match (optional)

Programme

"On Hold" Records (H)

Receipt Nr (optional) 1558280

All (U,P,X)

All Records (for s/n or receipt nr)

Export Nr (exclusive)

Exported, No Results From CBS

LR2000 User (defaults to login) ALL

New (not yet exported)

Query

Reset

User

	Resend?	Export Nr	A/D	Serial Nr	Mult	Code	\$ Amount	Remarks	Receipt Nr	LR2000 User	#Msg
1	<input type="checkbox"/>	1489930	A	AMC361755		582	125.00	2008	1558280	P5BROWN	1

366532

383267

361755

361955

NOTICE!!

These documents have been scanned!

Do not place un-scanned documents beneath this notice!

Do not remove this notice from this file!

GPO Jacket No. 560-102
Print Order 61540
Rise Business Services, LLC
Job=AZ15 5/28/2019



Box Number= AZ15090



Claim Begin-End: AMC383267-AMC383270

5 Miscellaneous



AZ15090-10

AMC381882-AMC383274

5-22-07

Dear BLM,

Please record these lead mining claims and maps.

Enclosed are 4 claims & maps and \$170.00 each for a total of \$680.00, the check is for that amount.

Please call me if you have any questions or problems.

Your Truly,

Pete Myers
620 430 3188
620 225 1991

RECEIVED
B.L.M. AZ STATE OFFICE
2007 MAY 30 A 10 42
PHOENIX, ARIZONA

ANC 983267

1. The above map depicts the KPD# 010 mining claim,
which is located in Section (s) 30 Township 27

3326

NOTICE!!

These documents have been scanned!

Do not place un-scanned documents beneath this notice!

Do not remove this notice from this file!

GPO Jacket No. 560-102
Print Order 61540
Rise Business Services, LLC
Job=AZ15 5/28/2019



Box Number= AZ15090



Claim Begin-End: AMC383267-AMC383270

6 Location Notices-Amendments and Supporting Documents



AZ15090-10

AMC381882-AMC383274

MINING CLAIM STATUS REPORT

Data Entry ok
MTP CHECKED BY ✓
GEO CHECKED BY ✓

LEAD SERIAL NO. AMC 383217 THROUGH AMC 383270

# <u>4</u> LODE	LOCATION FEE @ \$30 =	\$ <u>120</u>
# _____ PLACER	PROCESSING FEE @ \$15 =	\$ <u>60</u>
# _____ ASSOCIATION PL	MAINTENANCE FEE @ \$125 =	\$ <u>500</u>
# _____ MILL SITE	OVERAGE	\$ _____
# _____ TUNNEL SITE	SHORTAGE	\$ _____
	OTHER FEES	\$ _____
ENOUGH LOCATORS	TOTAL	\$ <u>680.00</u> <i>-ok</i>
YES [] NO []		

OVER-THE-COUNTER [] MAIL [] TIMELY FILED: YES [] NO []

LEGAL DESCRIPTION: T 235 R 20E SEC 30,31
T _____ R _____ SEC _____
T _____ R _____ SEC _____
T _____ R _____ SEC _____

BLM [] FOREST SERVICE [] CORONADO SUBJ TO PL 359: YES [] NO []

WILDERNESS AREA: NO [] YES [] Miller Peak *EAST END OF KPD #30 Extends onto Wilderness Area*

SPLIT ESTATE: SX [] PX [] SRHA [] OTHER [] _____ N/A []
PROPER NOTICE FILED IF LOCATED ON SRHA LANDS-YES [] NO [] N/A []

RECONVEYED MINERALS ON BLM LANDS REQUIRE OPENING ORDERS FROM 1944 TO 1993. OPEN TO ENTRY ON: _____ N/A []

COMMENTS/STATUS: VOID [] PARTIALLY VOID [] PVT MINERALS []
WITHDRAWN LANDS [] OTHER [] KPD #010, #011
Located across patented Mining Claims
patent # 45,395 (MS 2171)

Claimant acknowledges that portions of the following claim(s) site(s) may be void or voidable. Note: Claimant EXCLUDES All patented & Wdn lands on all 4 claims

Signature of claimant

FINAL ADJUDICATION 70 DATE 12-20-07

AMC 383267

LOCATION NOTICE

(LODE)

NOTICE IS HEREBY GIVEN that the KPD#010 lode mining claim has been located by P.M. Exploration LLC, whose current mailing address is 2207 Crescent Dr., Dodge City, KS 67801. The general course of this claim is ESE TO WNW and it is situated in COCHISE County, Arizona. HARTFORD MINING DISTRICT.

This Claim is 1475 Feet in length and 590 Feet in width. This claim runs from location monument on which this location notice is posted approximately 737.5 Feet in a Easterly direction to the Eastern end line and 737.5 in a Westerly direction to the Western end line. This claim is marked by six monuments, one at each corner and one at the center of each end line of the claim.

The location monument on which this notice is posted is situated within Section 30, T.-23-S., R.-20-E., G&SRM, Arizona, and this claim encompasses portions of the following quarter section (s), Section (s), Township(s) and Range (s): SW/4 AND SE/4 OF SECTION 30, T-23-S, R-20-E. G&SRM, Arizona.

THIS CLAIM EXCLUDES AND DOES NOT INCLUDE ANY PRIVATE LAND AND OR PATENTED LAND AND OR LAND WITHDRAWN FROM MINERAL ENTRY.

The locality of this claim with reference to some natural object or permanent monument and additional information (if any) concerning its locality are as follows: FROM U.S.L.M 2171 TO THE SOUTHWEST CORNER OF KPD #010 THE APP. BEARING OF 246° FOR THE APP. DISTANCE OF 536 FT. SOUTHERN LINE OF KPD #010 IS THE SAME AS THE NORTHERN LINE OF KPD #011.

DATED AND POSTED on the ground this 16th day of May 2007

LOCATOR: Pete Myers
PETE MYERS

PHOENIX, ARIZONA
2007 MAY 30 A 10:42
RECEIVED
B.L.M. AZ STATE OFFICE

AMC 383267

CLAIM MAP
K.P.D. #011

Lode (XX)
Placer (XX)

NORTH

BEARINGS IN DEGREES

DISTANCES IN FEET

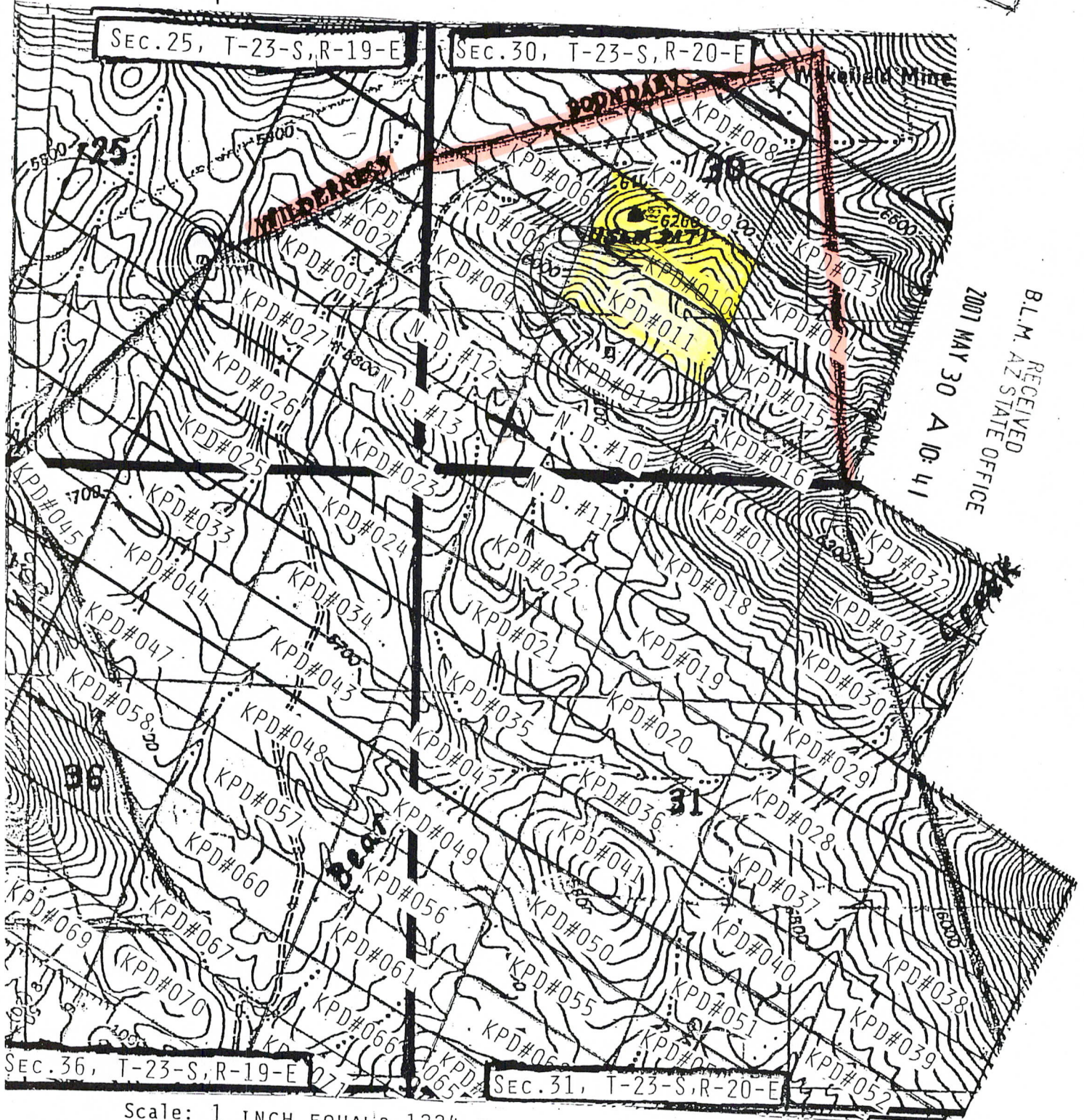
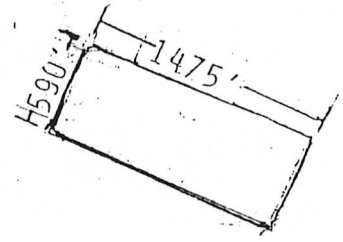
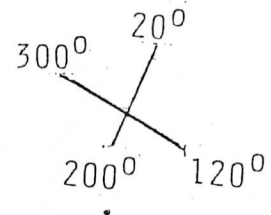

RECEIVED
BLM, AZ STATE OFFICE
2007 MAY 30 A 10:41

Scale: 1 INCH EQUALS 1224 FT.

1. The above map depicts the KPD# 011 mining claim,
which is located in Section (s) 30

AN

LOCATION NOTICE

(LODE)

NOTICE IS HEREBY GIVEN that the KPD#011 lode mining claim has been located by P.M. Exploration LLC, whose current mailing address is 2207 Crescent Dr., Dodge City, KS 67801. The general course of this claim is ESE TO WNW and it is situated in COCHISE County, Arizona. HARTFORD MINING DISTRICT.

This Claim is 1475 Feet in length and 590 Feet in width. This claim runs from location monument on which this location notice is posted approximately 737.5 Feet in a Easterly direction to the Eastern end line and 737.5 in a Westerly direction to the Western end line. This claim is marked by six monuments, one at each corner and one at the center of each end line of the claim.

The location monument on which this notice is posted is situated within Section 30, T-23-S, R-20-E, G&SRM, Arizona, and this claim encompasses portions of the following quarter section (s) , Section (s) , Township(s) and Range (s): SW/4 AND SE/4 OF SECTION 30, T-23-S, R-20-E. G&SRM, Arizona.

THIS CLAIM EXCLUDES AND DOES NOT INCLUDE ANY PRIVATE LAND AND OR PATENTED LAND AND OR LAND WITHDRAWN FROM MINERAL ENTRY.

The locality of this claim with reference to some natural object or permanent monument and additional information (if any) concerning its locality are as follows: FROM U.S.L.M 2171 TO THE NORTHWEST CORNER OF KPD #011 THE APP. BEARING OF 246° FOR THE APP. DISTANCE OF 536 FT. SOUTHERN LINE OF KPD #011 IS THE SAME AS THE NORTHERN LINE OF KPD #012.

DATED AND POSTED on the ground this 16th day of May 2007

LOCATOR :

Pete Myers

PETE MYERS

PHOENIX, ARIZONA
2007 MAY 30 A 10:41
RECEIVED
B.L.M. AZ STATE OFFICE

AMC 383268

LOCATION NOTICE

(LODE)

NOTICE IS HEREBY GIVEN that the KPD#029 lode mining claim has been located by P.M. Exploration LLC, whose current mailing address is 2207 Crescent Dr., Dodge City, KS 67801. The general course of this claim is ESE TO WNW and it is situated in COCHISE County, Arizona. HARTFORD MINING DISTRICT.

This Claim is 1475 Feet in length and 590 Feet in width. This claim runs from location monument on which this location notice is posted approximately 737.5 Feet in a Easterly direction to the Eastern end line and 737.5 in a Westerly direction to the Western end line. This claim is marked by six monuments, one at each corner and one at the center of each end line of the claim.

The location monument on which this notice is posted is situated within Section 31, T-23-S, R-20-E, G&SRM, Arizona, and this claim encompasses portions of the following quarter section (s), Section (s), Township(s) and Range (s): NE/4 AND SE/4 OF SECTION 31, T-23-S, R-20-E G&SRM, Arizona.

THIS CLAIM EXCLUDES AND DOES NOT INCLUDE ANY PRIVATE LAND AND OR PATENTED LAND AND OR LAND WITHDRAWN FROM MINERAL ENTRY.

The locality of this claim with reference to some natural object or permanent monument and additional information (if any) concerning its locality are as follows: FROM U.S.L.M 2171 TO THE SOUTHEAST CORNER OF KPD #029 THE APP. BEARING OF 155° FOR THE APP. DISTANCE OF 4667 FT. WESTERN LINE OF KPD #029 IS THE SAME AS THE EASTERN LINE OF KPD #019.

DATED AND POSTED on the ground this 16th day of May 2007

PHOENIX, ARIZONA

2007 MAY 30 A 10:41

RECEIVED
B.L.M. AZ STATE OFFICE

LOCATOR(S):

Pete Myers
Pete Myers

AMC 383269

CLAIM MAP
KPD#029

Lode (XX)
Placer ()

DISTANCES IN FEET

NORTH

BEARINGS IN DEGREES

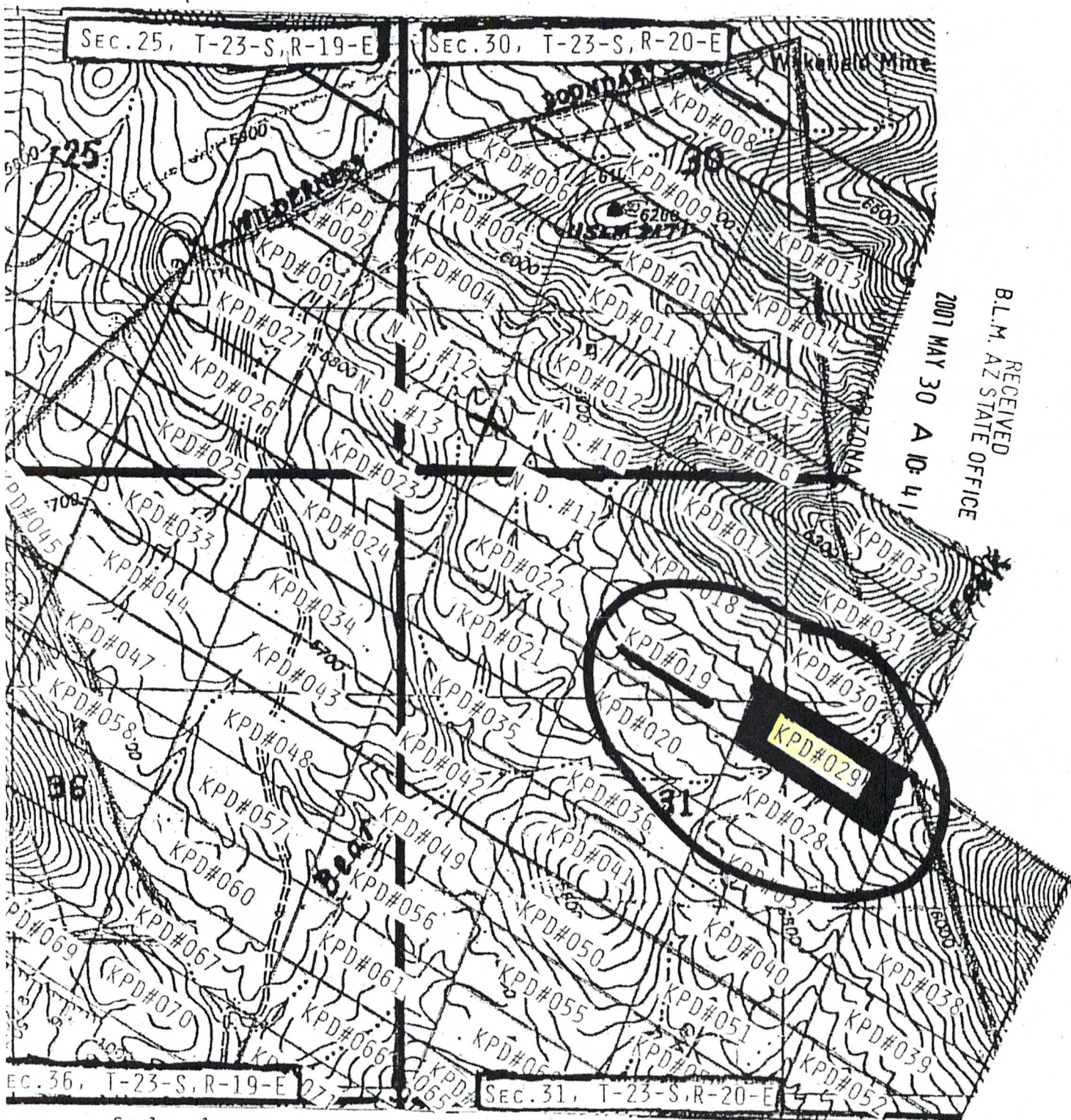
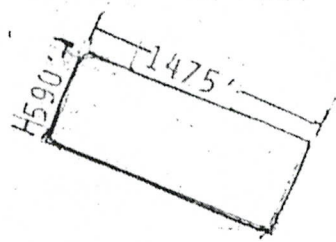
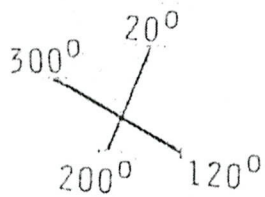

RECEIVED
B.L.M. AZ STATE OFFICE
2007 MAY 30 A 10:41

Scale: 1 INCH EQUALS 1224 FT.

1. The above map depicts the KPD# 029 mining claim,
which is located in Section ()

AMC

LOCATION NOTICE

(LODE)

NOTICE IS HEREBY GIVEN that the KPD#030 lode mining claim has been located by P.M. Exploration LLC, whose current mailing address is 2207 Crescent Dr., Dodge City, KS 67801. The general course of this claim is ESE TO WNW and it is situated in COCHISE County, Arizona. HARTFORD MINING DISTRICT.

This Claim is 1475 Feet in length and 590 Feet in width. This claim runs from location monument on which this location notice is posted approximately 737.5 Feet in a Easterly direction to the Eastern end line and 737.5 in a Westerly direction to the Western end line. This claim is marked by six monuments, one at each corner and one at the center of each end line of the claim.

The location monument on which this notice is posted is situated within Section 31, T.-23-S., R.-20-E., G&SRM, Arizona, and this claim encompasses portions of the following quarter section (s), Section (s), Township(s) and Range (s): NE/4 OF SECTION 31, T-23-S, R-20-E G&SRM, Arizona.

THIS CLAIM EXCLUDES AND DOES NOT INCLUDE ANY PRIVATE LAND AND OR PATENTED LAND AND OR LAND WITHDRAWN FROM MINERAL ENTRY.

The locality of this claim with reference to some natural object or permanent monument and additional information (if any) concerning its locality are as follows: FROM U.S.L.M 2171 TO THE NORTHWEST CORNER OF KPD #030 THE APP. BEARING OF 163° FOR THE APP. DISTANCE OF 3709 FT. WESTERN LINE OF KPD #030 IS THE SAME AS THE EASTERN LINE OF KPD #018.

DATED AND POSTED on the ground this 16th day of May 2007.

PHOENIX, ARIZONA

2007 MAY 30 4 10 41

RECEIVED B.L.M. AZ STATE OFFICE

LOCATOR (S):

Pete Myers
Pete Myers

AMG 383270

CLAIM MAP
KPD#030

NORTH

BEARINGS IN DEGREES

Lode Placer (XX)

DISTANCES IN FEET

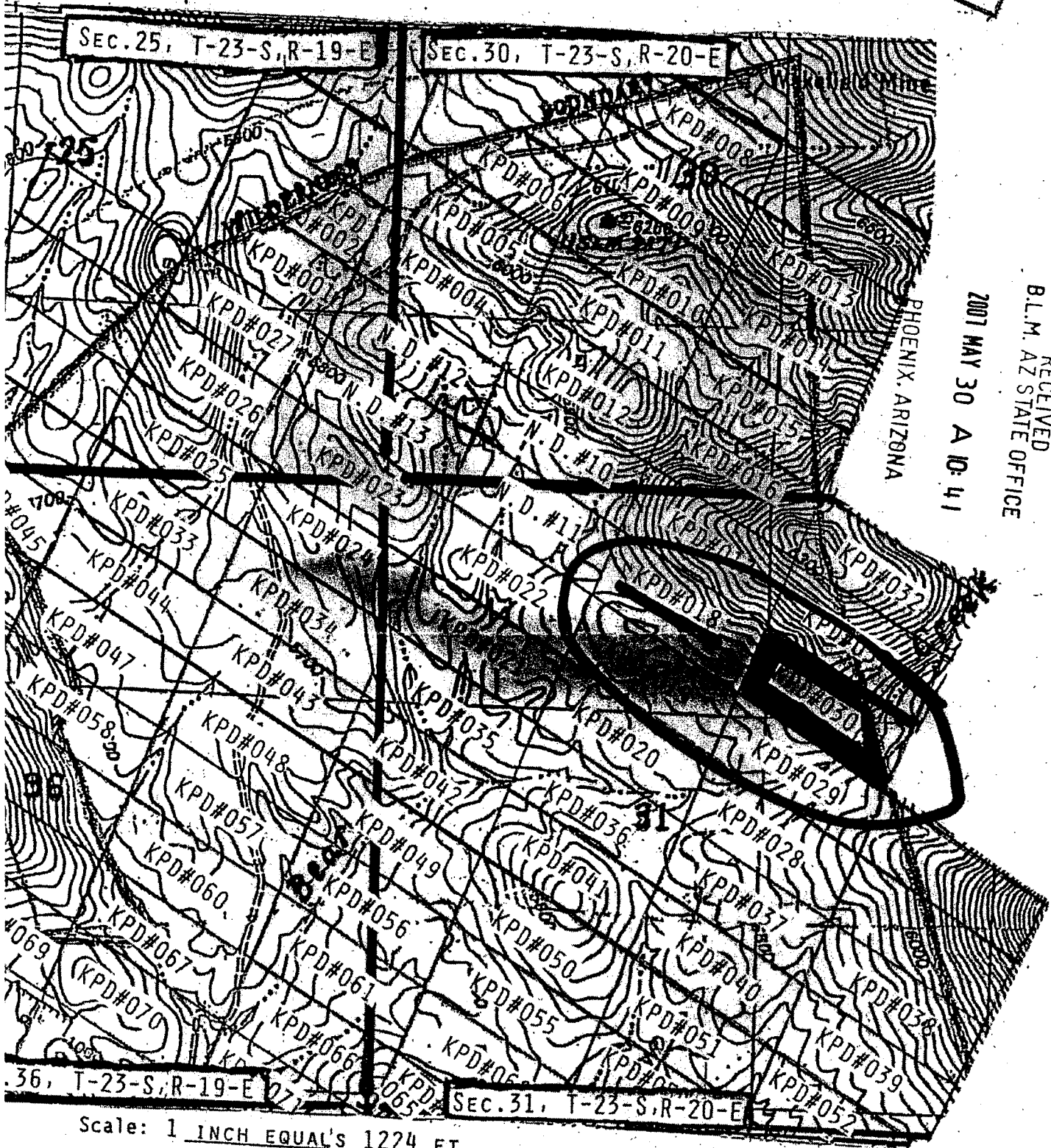
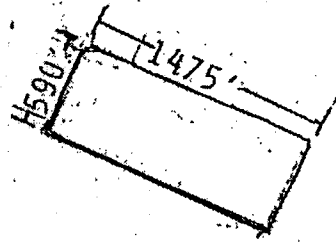
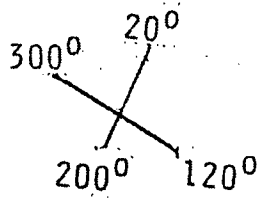

RECEIVED
BLM. AZ STATE OFFICE
2001 MAY 30 A 10:41

Scale: 1 INCH EQUALS 1224 FT.

1. The above map depicts the KPD# 030 mining claim,
which is located in Section (s) 31, Township 23

AMC 38571

Input Parameters for Geographic Report with Land

System Id = CR

Admin State = AZ

Geo State = AZ

Casetype Begins With

Case Disp Txt = AUTHORIZED, CANCELLED, EXPIRED, PENDING, REJECTED, RELINQUISHED, WITHDRAWN

Mer Twp Rng =

Section =

Mtrs = 14 0230S 0200E 030, 14 0230S 0200E 031

Commodity =

Commodity Txt =

Pending Org =

Pend Org Decode =

Total Rows Returned: 2

RUN TIME: 03:11 PM

Adm State: AZ

UNITED STATES DEPARTMENT OF INTERIOR
BUREAU OF LAND MANAGEMENT
GEOGRAPHIC REPORT WITH LAND
Sorted by Meridian Township Range

RUN DATE: 06/04/2007
Page 1 of 1

Serial Number: AZA 028556
Total Case Acres: 20,131.000

<u>Casetype</u>	<u>Case Disp</u>	14	0230S	0200E	<u>Sect</u>	<u>Sur Typ</u>	<u>Sur Num</u>	<u>Suff</u>	<u>Subdivision</u>	<u>Act Pend</u>
232107	AUTHORIZED				030	FF		1	M&B;	
	<i>wilderness</i>				031			1		

SRP_s are correct

Claims fall w/in lands

for Miller Peak Wilderness
area.

6/5
DJD